

This Owner's Manual is provided and hosted by [Appliance Factory Parts](#).



Coleman 9948-725 Owner's Manual

[Shop genuine replacement parts for Coleman 9948-725](#)



[Find Your Coleman Camping Parts - Select From 855 Models](#)

----- Manual continues below -----



Propane Stove 9948 Series

INSTRUCTIONS FOR USE

U.S. and other Patents Pending
© 2004 The Coleman Company, Inc.
www.coleman.com



IMPORTANT

Read this manual carefully before assembling, using or servicing this stove. Keep this manual for future reference. If you have questions about assembly, operation, servicing or repair of this stove, please call Coleman at 1-800-835-3278 or TDD: 316-832-8707. In Canada call 1-800-387-6161.

For Outdoor Use Only



ANSI Z21.89a - CSA 1.18a (2003)
Outdoor Cooking Specialty Gas Appliances

Contents

General Safety Information
To Set up
Using the Propane Cylinder Support
Leak Check
Operation
To Light
Before Cooking
To Turn Off
Tear Down/Clean
Storage
Maintenance
Troubleshooting
Service
Things You Should Know
Replacement Parts List
Accessories
Warranty

FOR YOUR SAFETY

If you smell gas:

1. Shut off gas to the appliance.
2. Extinguish any open flame.
3. Open lid.
4. If odor continues, immediately call your gas supplier or your fire department.

FOR YOUR SAFETY

1. Do not store or use gasoline or other flammable vapors in the vicinity of this or any other appliance.
2. When cooking with oil/grease, do not allow the oil/grease to exceed 350°F (176.5°C). Do not store or use any extra cooking oil in the vicinity of this or any other appliance.
3. An LP cylinder not connected for use shall not be stored in the vicinity of this or any other appliance.

! DANGER



• CARBON MONOXIDE HAZARD

- This appliance can produce carbon monoxide which has no odor.
- Using it in an enclosed space can kill you.
- Never use this appliance in an enclosed space such as a camper, tent, car or home.

! WARNING

1. Do not store spare LP cylinder within 10 feet (3m) of this appliance.
2. Do not store or use gasoline or other flammable liquids or vapors within 25 feet (8m) of this appliance.
3. When cooking with oil/grease, do not allow oil/grease to get hotter than 350°F (176.5°C).
4. Do not leave oil/grease unattended.

General Safety Information

This manual contains important information about the assembly, operation and maintenance of this outdoor stove. General safety information is presented in these first few pages and is also located throughout the manual. Particular attention should be paid to information accompanied by the safety alert symbols: “! DANGER”, “! WARNING”, “! CAUTION”.

Keep this manual for future reference and to educate new users about this product. This manual should be read in conjunction with the labeling on the product.

Safety precautions are essential when any mechanical or propane-fueled equipment is involved. These precautions are necessary when using, storing, and servicing. Using this equipment with the respect and caution demanded will reduce the possibilities of personal injury or property damage.

The symbols shown below and on page 3 are used extensively throughout this manual. Always heed these precautions, as they are essential when using any mechanical or fueled equipment.

! DANGER

DANGER indicates an imminently hazardous situation which, if not avoided, will result in death or serious injury.

! WARNING

WARNING indicates a potentially hazardous situation which, if not avoided, could result in death or serious injury.

! CAUTION

CAUTION indicates a potentially hazardous situation which, if not avoided, may result in minor or moderate personal injury, or property damage.

! WARNING: For Outdoor Use Only

! WARNING

Improper installation, adjustment, alteration, service or maintenance can cause injury or property damage. Read the Installation, Operation, & Maintenance Instructions thoroughly before installing or servicing this equipment.

DANGER

Failure to comply with the precautions and instructions provided with this outdoor stove can result in death, serious bodily injury and property loss or damage from hazards of fire, explosion, burn, asphyxiation, and/or carbon monoxide poisoning.

Only persons who can understand and follow the instructions should use or service this outdoor stove.

If you need assistance or outdoor stove information such as an instruction manual or labels, contact the Coleman Co., Inc.

DANGER



• EXPLOSION - FIRE HAZARD

- Never store propane near high heat, open flames, pilot lights, direct sunlight, other ignition sources or where temperatures exceed 120 degrees F (49°C).
- Propane is heavier than air and can accumulate in low places. If you smell gas, leave the area immediately.
- Never install or remove propane tank while outdoor stove is lighted, near flame, pilot lights, other ignition sources or while outdoor stove is hot to touch.
- During operation, this product can be a source of ignition. Never use the stove in spaces that contain or may contain volatile or airborne combustibles, or products such as gasoline, solvents, paint thinner, dust particles or unknown chemicals. Minimum clearances from combustible materials: 12" from the sides & 48" from the top.
- Provide adequate clearances around air openings into the combustion chamber.
- DO NOT use gas stove indoors or store any propane cylinder(s) indoors, including in the garage, breezeways, sheds or enclosed areas.
- Never locate stove under an unprotected combustible material or overhang which is connected to a building.
- Do not obstruct the flow of combustion and ventilation air.
- Keep the ventilation opening(s) of the cylinder enclosure free and clear from debris.
- Stove must be on a level, stable surface in an area clear of combustible material. An asphalt surface (blacktop) may not be acceptable for this purpose.

WARNING

We cannot foresee every use which may be made of this cooking stove. **Check with your local fire safety authority if you have questions about use.**

Other standards govern the use of fuel gases and heat producing products for specific uses. Your local authorities can advise you about these.

- Never refill disposable cylinders.
- Use the preset regulator that came with the stove. Do not attempt to adjust.
- The installation must conform with local codes or, in absence of local codes, with the *National Fuel Gas Code, ANSI Z223.1/NFPA 54, Storage and Handling of Liquefied Petroleum Gases, ANSI/NFPA 58* or *CSA B149.1, Natural Gas and Propane Installation Code.*
- This appliance is not intended to be installed in or on recreational vehicles and/or boats.
- This appliance is not intended for commercial use.

DANGER



• CARBON MONOXIDE HAZARD

- This stove is a combustion appliance. All combustion appliances produce carbon monoxide (CO) during the combustion process. This product is designed to produce extremely minute, nonhazardous amounts of CO if used and maintained in accordance with all warnings and instructions. Do not block air flow into or out of the cook stove.
- Carbon Monoxide (CO) poisoning produces flu-like symptoms, watery eyes, headaches, dizziness, fatigue and possibly death. You can't see it and you can't smell it. It's an invisible killer. If these symptoms are present during operation of this product **get fresh air immediately!**
- **For outdoor use only.**
- **Never use inside house, or other unventilated or enclosed areas. This cook stove consumes air (oxygen). Do not use in unventilated or enclosed areas to avoid endangering your life.**

WARNING

- This product is fueled by propane gas. Propane gas is invisible, odorless, and flammable. An odorant is normally added to help detect leaks and can be described as a "rotten egg" smell. The odorant can fade over time so leaking gas is not always detectable by smell alone.
- Propane gas is heavier than air and leaking propane will sink to the lowest level possible. It can ignite by ignition sources including matches, lighters, sparks or open flames of any kind many feet away from the original leak. Use only propane gas set up for vapor withdraw.
- Propane gas should be stored and used in compliance with local ordinances and codes or with ANSI/NFPA 58. Turn off propane when not in use.

CALIFORNIA PROPOSITION 65:

WARNING: Propane and byproducts of combustion of propane contain chemicals known to the state of California to cause cancer, birth defects, or other reproductive harm.

WARNING



• BURN HAZARD

- Never leave the outdoor stove unattended when hot or in use.
- Keep out of reach of children.

CAUTION

• SERVICE SAFETY

- Keep all connections and fittings clean. Inspect propane cylinder and stove propane connections for damage before attaching.
- During set up, check all connections and fittings for leaks using soapy water. Never use a flame. Bubbles indicate a leak. Check that the connection is not cross-threaded and that it is tight. Perform another leak check. If there is still a leak, remove the cylinder and contact Coleman for service or repairs.
- Use as a cooking appliance only. Never alter in any way or use with any device or part not expressly approved by Coleman.
- Clean stove frequently to avoid grease accumulation and possible grease fires.

⚠ WARNING

- Keep children and pets away from appliance at all times.
- NEVER leave the stove unattended while it is in use.
- The use of alcohol, prescription or non-prescription drugs may impair the consumer's ability to properly assemble or safely operate the appliance.
- Do not place empty cooking vessel on the appliance while in operation. Use caution when placing anything in cooking vessel while the appliance is in operation.
- DO NOT move the appliance when in use. Allow the cooking vessel to cool before moving or storing.
- This appliance is not intended for and should never be used as a heater.
- Cylinders must be stored outdoors out of reach of children.

To Set Up

CONSUMER NOTICE: These assembly instructions are designed for *more than one* stove model. Features shown **MAY NOT** be in your stove and will not be provided by this company or at the place you purchased your stove.

Step 1

- Remove stove, legs and regulator from packaging.
 - Regulator is packed in the end of the Styrofoam near front of stove.
 - Inspect all packing and remove all parts.
 - See carton for parts included with your unit.
- (1) Stove
(1) Lid
(1) Regulator
(1) Cooking Grate
(1) 1/2 Grill
(1) Full Griddle
(4) Legs
(1) Storage Bag
(1) 5-ft. Hose
- See replacement parts list for identification.



Install Legs (standard with some models)

Step 1

- Use a ground cloth to protect the finish.
- Remove Legs from storage bag.
- Thread Legs into Receivers on bottom of stove.



Install Legs (standard with some models) cont.

Step 1

- Stand stove upright and adjust Leg Levelers if necessary.



Step 2

- Open stove Lid.
- Insert Wire Clips on Wind Baffles into slots on side of stove as shown.

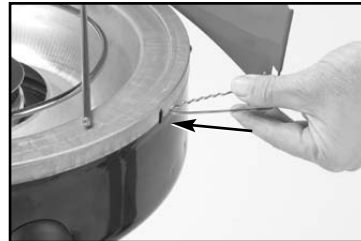

Step 3

- Place Cooking Grate onto stove.



Install 1/2 Griddle (standard with some models)

- Place 1/2 Griddle on Cooking Grate as shown.



Install Full Griddle (standard with some models)

NOTE: Before using the Full Griddle, remove the Cooking Grate.

■ Place Full Griddle on stove making sure Griddle Pins rest on stove as shown in Detail "A."



Using the Propane Cylinder Support

■ If using the stove on a tabletop, allow the base of the propane cylinder to rest on the surface of the tabletop. Do not use the propane cylinder support.

■ If using the stove with its Legs, pull up and rotate bottle support assembly until support wire is perpendicular to stove case.

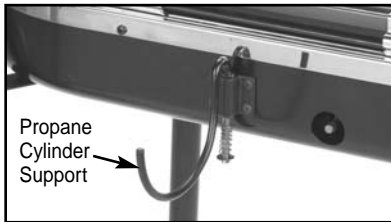

Leak Check

⚠ WARNING

- Perform leak test outdoors.
- Extinguish all open flames.
- NEVER leak test when smoking.
- Do not use the outdoor stove until connection has been leak tested and does not leak.

NOTE: Use Coleman 16.4 oz disposable propane cylinders. The LP gas cylinder(s) used with stoves must be constructed and marked in accordance with the specifications for LP-gas cylinders of the U.S. Department of Transportation or *Transport Canada, CAN/CSA B339.*

Step 1

■ Make sure Burner Valve is off.



Leak Check *cont.*

Step 2

■ Remove plastic cap from top of propane cylinder. Save cap for use in storing. Screw propane cylinder into REGULATOR. Be careful not to cross-thread. **HAND TIGHTEN** only.



Step 3

■ Check the connection between the cylinder and the regulator with soapy water. Bubbles indicate a leak. Check that the connection is not cross-threaded and that it is tight. Perform another leak check. If there is still a leak, remove the cylinder and contact Coleman for service or repairs.



■ The regulator uses a threaded fitting to attach to the stove. It is necessary to hold the stove to make sure the fitting is seated. Align the regulator to the fuel tube on the rear of the stove and push on. Screw on the outer threaded sleeve in a clockwise direction until tight.



Step 4

■ Never operate stove with propane cylinder in an inverted position.



Operation

⚠ DANGER



• CARBON MONOXIDE HAZARD

- For outdoor use only.
- Never use inside house, or other unventilated or enclosed areas. This outdoor stove consumes air (oxygen). Do not use in unventilated or enclosed areas to avoid endangering your life.

⚠ DANGER



• EXPLOSION - FIRE HAZARD

- Never store propane near high heat, open flames, pilot lights, direct sunlight, other ignition sources or where temperatures exceed 120°F (49°C).
- Propane is heavier than air and can accumulate in low places. If you smell gas, leave the area immediately.
- Never install or remove propane tank while outdoor stove is lighted, near flame, pilot lights, other ignition sources or while outdoor stove is hot to touch.
- This stove is red hot during use and can ignite flammables too close to the burner. Keep flammables at least 12" from sides and 48" from top. Keep gasoline and other flammable liquids and vapors well away from outdoor stove.
- Disconnect propane tank from stove if the stove is to be stored indoors.

■ Do not attempt to operate until you have read and understood all General Safety Information in this manual and all assembly is complete and leak checks have been performed.

Setup with Hose* and Refillable Cylinder

(*standard with some models)

Step 1

- Make sure Burner Valve is off.

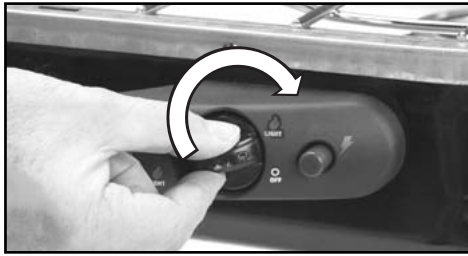

Step 2

- Attach Hose and Regulator to stove.
- Attach Hose to Cylinder.

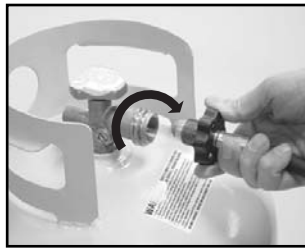
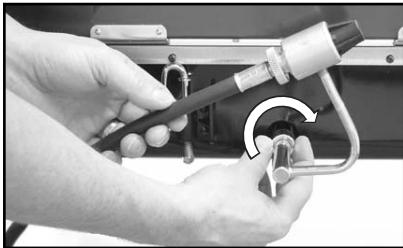

Setup with Hose* and Refillable Cylinder *cont.*

(*standard with some models)

Step 3

- Perform leak check on Hose to Regulator, and Hose to Cylinder connections with soapy water. Bubbles indicate a leak. Check that the connection is not cross-threaded and that it is tight. Perform another leak check. If there is still a leak, remove the cylinder and contact Coleman for service or repairs.

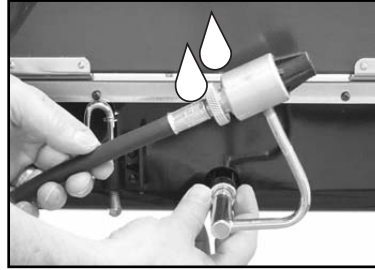

To Light

- Open the stove lid. Do not attempt to light the stove with lid closed.
- Open BURNER VALVE and push igniter button several times until burner lights. (If the stove is wet, the igniter may not spark until it dries out.)



- The unit may be match lighted if there is no ignition.
- First, remove grill surface.
- Hold lighted match next to BURNER and open BURNER VALVE slowly.



- Adjust flame to desired heat level.
- Flame should be blue with a hint of yellow on tips.



Before Cooking

⚠ CAUTION

- Do not place a pot or a pan on griddle surface. Damage will occur and void the warranty.

- Clean cooking surface and cooktop with warm water and detergent before first use.
- The lid is removable. Tilt forward and lift.



To Turn Off

- Push the burner valve knob inward and close burner valve firmly.

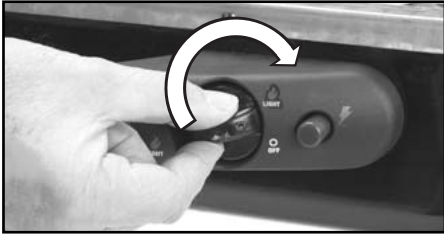

Tear Down/Clean

- Be sure stove is cool.
- Always detach propane cylinder outdoors away from ignition sources.
- Unscrew the threaded outer sleeve that connects the regulator to the stove by turning it counterclockwise then remove regulator from the stove fuel line.
- Detach propane cylinder from regulator and replace the plastic protective cap onto cylinder threads.



Tear Down/Clean cont.

- Clean griddle with warm water and mild household cleaner. Do not use abrasives.
- Wipe the stove clean with soft cloth and mild household cleaner. Do not use abrasives.



- The 1/2 griddle can be placed in dishwasher for easy cleaning.



To Remove Legs from Stove

- Place stove on side on a ground cloth to protect the stove finish.
- Remove legs by unscrewing from receivers on bottom of stove.

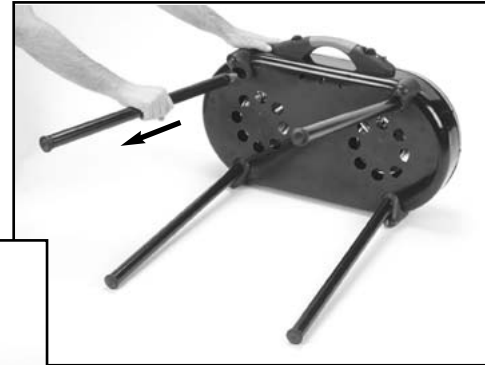

- Thread foot pad into leg.



- Close Lid. Make sure Latch engages.

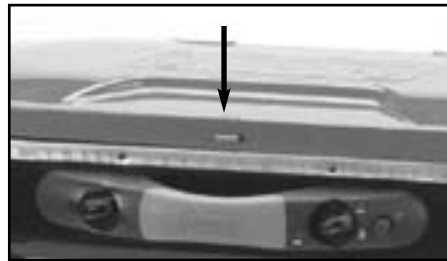

Storage

- Disconnect regulator from cylinder. If stored indoors, detach and leave cylinder outdoors.
- Store propane tank in safe manner. Refer to Chapter 5 of *Standard for Storage and Handling of Liquefied Gases*, ANSI/NFPA 58. Follow all local codes. Always store propane tanks outdoors.
- Store stove in a dry, clean and safe place.
- Place the cleaned cooking grid, griddle and REGULATOR into the stove for storage.
- For long-time storage, clean and dry all stove parts before storing. This will keep the unit clean and ready for the next season.
- Place the stove in a plastic bag and tie it shut.

Maintenance

WARNING



• BURN HAZARD

- Do not touch or attempt any maintenance on stove for at least one hour after use.
- Make sure all controls are off and propane tank has been removed before doing maintenance.

To enjoy years of outstanding performance from your stove, perform the following maintenance activities on a regular basis:

- Keep exterior surfaces clean.
- Use warm soapy water for cleaning. Never use flammable or abrasive cleaning agents.

- Airflow must be unobstructed. Keep controls, burner and circulating air passages clean. Signs of possible blockage include:
 - Gas odor
 - Stove makes popping noises
 - Smoky flame.
- Spiders and insects can nest in burner orifices. This condition can damage the stove and render it unsafe for use. Clean burner holes by using a heavy-duty pipe cleaner. Compressed air may help clear away small particles.
- Carbon deposits may create a fire hazard. Clean burner with warm soapy water if any carbon deposits develop.
- If the stove has been left uncovered and is wet from rain, snow, yard sprinklers, etc., allow to dry (at least 30 minutes prior to use).
- **NOTE:** In a salt-air environment (such as near an ocean), corrosion occurs more quickly than normal. Frequently check for corroded areas and repair them promptly.

Troubleshooting

Problem	Possible Cause	Solution
Burner won't light	Gas pressure is low.	Cylinder is empty. Replace cylinder.
	Air in gas line.	Burner may take up to one minute to light after a propane bottle has been connected.
	Igniter is wet.	Light the stove with a match.
Burner won't stay lit	Dust and/or dirt built up around burner	Clean dirt and/or dust from around burner.
Burner flame is low	Gas pressure is low	Replace cylinder.
	Outdoor temperature is less than 40°F and tank is less than 1/4 full.	Use a full cylinder.
	Fuel flow is restricted.	Check burner and orifices for blockage. Adjust control knob to full ON position.
Improper Flame (Flame should be blue with hint of yellow on tips)	Fuel flow is restricted.	Check burner, orifices and venturi for blockage (bugs, dirt, cobwebs).

Service

- Repair to gas passages and associated components should be done only by Coleman or an authorized service person.
- Owner repair and service should be limited and performed only to the following:
 - Cleaning
 - Cylinder replacement
- For Authorized Repair & Service, call 1-800-835-3278.

Things you should know

1. It is unsafe and illegal in some places to store or use propane cylinders of greater than 1.14 kg (2.5 lbs) water capacity (approximately 1 lb. propane) in occupied enclosures.
2. If using refillable propane cylinder, use only Coleman parts and accessories.
3. The usual storage areas for camping and picnic equipment are the basement, attic, or garage. To avoid the accumulation of dust, cobwebs, etc., that is common in these areas, place your stove in optional carry case (sold separately) or a plastic bag and seal it with a rubber band.
4. For repair service call one of the numbers listed on the cover of this manual for location of your nearest Coleman Service Center. If product must be mailed to Service Center, attach to product your name, address and a description of problem and mail to Service Center with shipping and **insurance** prepaid. If necessary to write the Service Center or factory, refer to your stove by model number. **Do not send propane cylinder.**
5. If not completely satisfied with the performance of this product, please call one of the numbers listed on the cover of this manual.

Replacement Parts 9948- Series Stove

Parts List

No. Part No. Description

1	9942-5851	Igniter/Electrode Assembly
2	9944-1611	E.I. Button
3	9944-1751	Saddle Assembly
4	9944-1881	Adjustable Foot Pad
5	9948-5251	Regulator Assembly
6	9948-1021	Lid Assembly
7	9948-1801	Leg Assembly
8	9948-1881	Foot Bracket w/fasteners
9	9948-3861	Control Handle Assembly w/fasteners
10	9948-1571	Cooking Grate
11	9948-3201	Burner Assembly, Left
12	9948-3211	Burner Assembly, Right
13	9948-1491	Control Knob

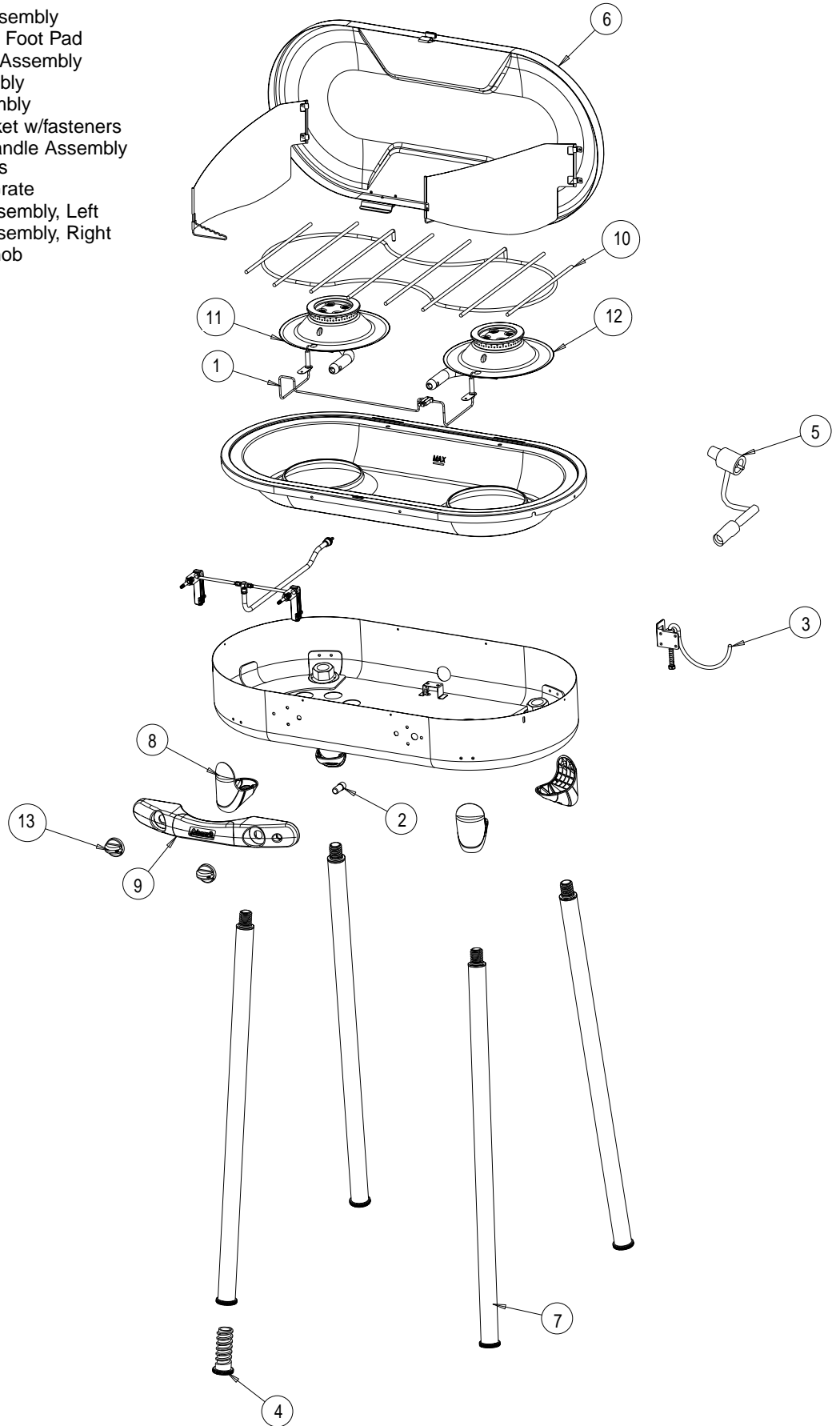

Accessories

The following accessories are available:



- Griddle – Nonstick Cast Aluminum
R9948-317C



- 5 ft. High Pressure Hose & Adapter (connects appliance to refillable propane cylinder)
5470-7931

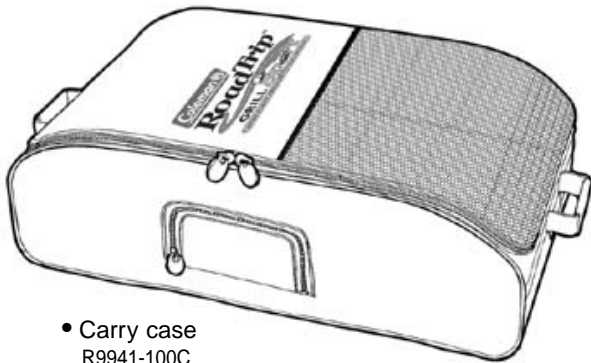

- Carry case
R9941-100C



- Griddle Nonstick Cast Aluminum
R9941-325C

Visit us at www.coleman.com
or
call us at 1 800 835-3278

Coleman Limited 5 Year Warranty

The Coleman Company, Inc. ("Coleman") warrants that for a period of five years from the date of original retail purchase, this product will be free from defects in material and workmanship. Coleman, at its option, will repair or replace this product or any component of the product found to be defective during the warranty period. Replacement will be made with a new or remanufactured product or component. If the product is no longer available, replacement may be made with a similar product of equal or greater value. This is your exclusive warranty.

This warranty is valid for the original retail purchaser from the date of initial retail purchase and is not transferable. Keep the original sales receipt. Proof of purchase is required to obtain warranty performance. Coleman dealers, service centers, or retail stores selling Coleman products do not have the right to alter, modify or in any way change the terms and conditions of this warranty.

This warranty does not cover normal wear of parts or damage resulting from any of the following: negligent use or misuse of the product, use on improper voltage or current, use contrary to the operating instructions, disassembly, repair or alteration by anyone other than Coleman or an authorized service center. Further, the warranty does not cover Acts of God, such as fire, flood, hurricanes and tornadoes.

COLEMAN SHALL NOT BE LIABLE FOR ANY INCIDENTAL OR CONSEQUENTIAL DAMAGES CAUSED BY THE BREACH OF ANY EXPRESS OR IMPLIED WARRANTY OR CONDITIONS. SOME STATES, PROVINCES OR JURISDICTIONS DO NOT ALLOW THE EXCLUSION OR THE LIMITATION OF INCIDENTAL OR CONSEQUENTIAL DAMAGES, SO THE ABOVE LIMITATION OR EXCLUSION MAY NOT APPLY TO YOU. EXCEPT TO THE EXTENT PROHIBITED BY APPLICABLE LAW, ANY IMPLIED WARRANTY OF MERCHANTABILITY OR FITNESS FOR A PARTICULAR PURPOSE IS LIMITED IN DURATION TO THE DURATION OF THE ABOVE WARRANTY OR CONDITIONS. SOME STATES, PROVINCES OR JURISDICTIONS DO NOT ALLOW LIMITATIONS ON HOW LONG AN IMPLIED WARRANTY LASTS, SO THE ABOVE LIMITATIONS MAY NOT APPLY TO YOU. This warranty gives you specific legal rights, and you may also have other rights that vary from state to state or province to province.

HOW TO OBTAIN WARRANTY SERVICE

Take the product to an authorized Coleman service center. You can find the nearest authorized Coleman service center by calling 1-800-835-3278 or TDD 316-832-8707 in the United States or 1-800-387-6161 in Canada. If a service center is not conveniently located, attach to the product a tag that includes your name, address, daytime telephone number and description of the problem. Include a copy of the original sales receipt. Carefully package the product and send either by UPS or Parcel Post **insured** with **shipping** and **insurance** prepaid to:

For products purchased in the United States:
The Coleman Company, Inc.
3600 North Hydraulic
Wichita, KS 67219

For products purchased in Canada:
Sunbeam Corporation (Canada) Limited
5975 Falbourne Street
Mississauga, Ontario
Canada L5R 3V8

Do not mail products with fuel in tanks, or with disposable propane cylinders.

DO NOT RETURN THIS PRODUCT TO THE PLACE OF PURCHASE.

If you have any questions regarding this warranty please call 1-800-835-3278 or TDD 316-832-8707 in the United States or 1-800-387-6161 in Canada.

The Coleman Co., Inc.
3600 N. Hydraulic
Wichita, KS 67219 U.S.A.
1-800-835-3278
TDD: 316-832-8707
www.coleman.com



The Coleman Co., Inc. • 3600 N. Hydraulic • Wichita, KS 67219 U.S.A.
1-800-835-3278 • TDD: 316-832-8707

©2004 The Coleman Company, Inc. All rights reserved.

Coleman® and  are registered trademarks of the Coleman Company, Inc.