

This Owner's Manual is provided and hosted by [Appliance Factory Parts](#).



# HAMILTON BEACH 47374 Owner's Manual

[Shop genuine replacement parts for HAMILTON  
BEACH 47374](#)



[Find Your HAMILTON BEACH Small Appliance Parts - Select From 252 Models](#)

----- Manual continues below -----

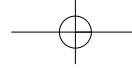

**READ BEFORE USE**  
**LIRE AVANT D'UTILISER**  
**LEA ANTES DE USAR**

Visit [hamiltonbeach.com](http://hamiltonbeach.com) for  
delicious recipes, tips, and to register  
your product online!



Consulter [hamiltonbeach.ca](http://hamiltonbeach.ca) pour les  
recettes délicieuses, conseils pratiques,  
et pour enregistrer votre produit!

¡Visite [hamiltonbeach.com.mx](http://hamiltonbeach.com.mx) para  
recetas deliciosas, consejos, y para  
registrar su producto en línea!

**Questions?**

Please call us – our friendly  
associates are ready to help.  
USA: 1.800.851.8900

**Questions?**

N'hésitez pas à nous appeler –  
nos associés s'empresseront  
de vous aider.  
CAN: 1.800.267.2826

**¿Preguntas?**

Por favor llámenos – nuestros  
amables representantes están  
listos para ayudar.

**MEX: 01 800 71 16 100**

*Le invitamos a leer cuidadosamente  
este instructivo antes de usar su  
aparato.*



**Hami**

*BrewS*

Engl  
Fran  
Espa

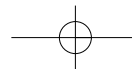

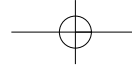

## IMPORTANT SAFEGUARDS

When using electrical appliances, basic safety precautions should always be followed to reduce the risk of fire, electrical shock, or injury to persons, including the following:

1. Read all instructions.
2. Do not touch hot surfaces. Use handles or knobs. Care must be taken, as burns can occur from touching hot parts or from spilled, hot liquid.
3. To protect against electric shock, do not place cord, plug, or BrewStation® in water or other liquid.
4. Close supervision is necessary when any appliance is used by or near children.
5. Unplug from outlet when either the BrewStation® or clock is not in use and before cleaning. Allow to cool before putting on or taking off parts and before cleaning the appliance.
6. Scalding may occur if the lid is lifted during the brewing cycle. Do not open lid until coffeemaker has cooled completely.
7. BrewStation® must be operated on a flat surface away from the edge of counter to prevent accidental tipping.
8. Do not operate any appliance with a damaged cord or plug, or after the appliance malfunctions or is dropped or damaged in any manner. Call our toll-free customer service number for information on examination, repair, or adjustment.
9. The use of accessory attachments not recommended by the appliance manufacturer may cause injuries.
10. Do not use outdoors.
11. Do not let cord hang over edge of table or rest on hot surfaces, including stove.
12. The coffee tank is designed for use with the coffee maker. It must never be used on a range top or in a microwave oven.
13. Do not place BrewStation® on or near a hot burner or in a heated oven.
14. To disconnect BrewStation®, turn controls off, unplug, and remove plug from wall outlet.
15. **WARNING!** To reduce the risk of fire or electrical shock, do not remove the bottom cover. No users should be inside. Repair should be done by authorized service personnel only.
16. Do not use appliance for other than intended use.

## SAVE THESE INSTRUCTIONS!

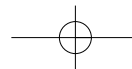

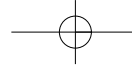

## IMPORTANT

Never use coffee tank to pour hot coffee or carry hot coffee.  
Handle coffee tank when it holds only cold water.

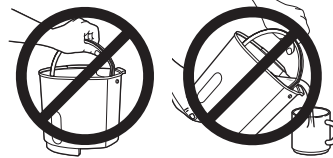

### Additional Information

- If overflow occurs: Let unit, coffee, and grounds cool completely before attempting any cleanup.
- Use only brand-name, high-quality filters.
- Use only 3/4 tablespoon of ground coffee for each cup of coffee.
- Use coffeemaker cleaner to prevent hard water deposits that affect coffeemaker performance. Clean monthly.
- Do not clean coffee tank in dishwasher.
- Read instructions before using.

### OTHER CONSUMER SAFETY INFORMATION

**This appliance is intended for household use only.**

**WARNING! Shock Hazard:** This appliance has a polarized plug (one wide blade) that reduces the risk of electric shock. The plug fits only one way into a polarized outlet. Do not defeat the safety purpose of the plug by modifying the plug in any way or using an adaptor. If the plug does not fit, reverse the plug. If it still does not fit, have an electrician replace the outlet.

The length of the cord used on this appliance reduce the hazards of becoming tangled in, or longer cord. If a longer cord is necessary, an cord may be used. The electrical rating of the must be equal to or greater than the rating of Care must be taken to arrange the extension not drape over the countertop or tabletop where on by children or accidentally tripped over.

To avoid an electrical circuit overload, do not wattage appliance on the same circuit with y

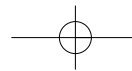
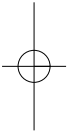

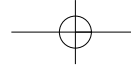

# Parts and Features

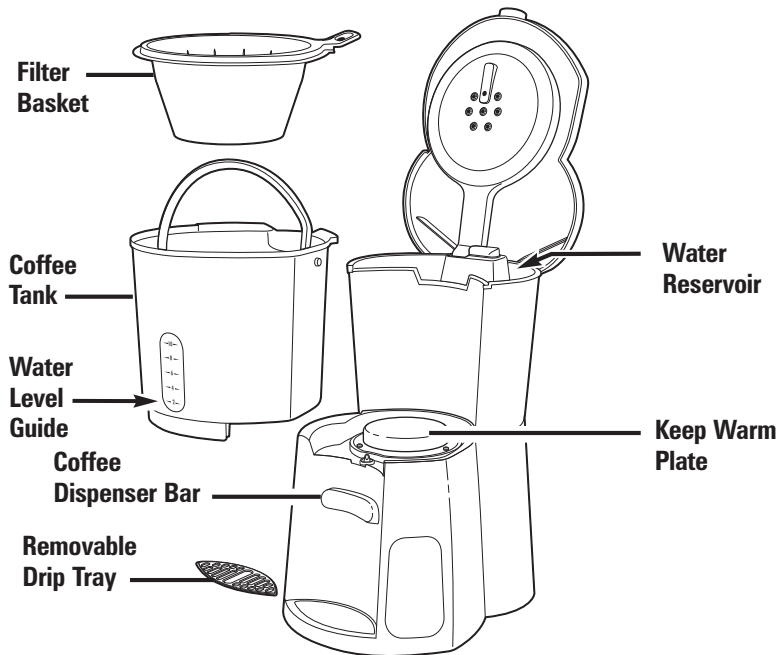

# Optional Accessories

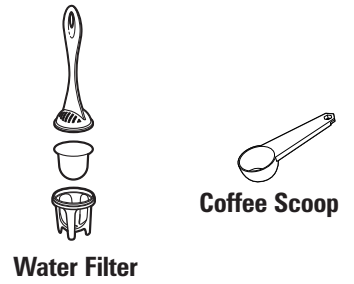

**To Order Call:**  
1.800.851.8900 (U.S.)  
1.800.267.2826 (Canada)  
01.800.71.16.100 (Mexico)  
or visit [hamiltonbeach.com](http://hamiltonbeach.com)

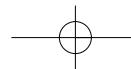

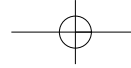

# How to Make Coffee

Before first use: Wash coffee tank, filter basket, and drip tray in hot, soapy water. NEVER put the coffee tank in dishwasher.

BrewStation® may have an automatic 2-hour shutoff. Press ON/OFF to shut off sooner.

**⚠ WARNING Burn Hazard.**

- Never use coffee tank to pour or carry hot coffee.
- Handle coffee tank only when holding cold water for fill and to clean tank after BrewStation® has been shut off.
- If BrewStation® overflows, allow unit, coffee, and grounds to cool before cleaning unit, coffee, or grounds.

*\*optional feature on select models*

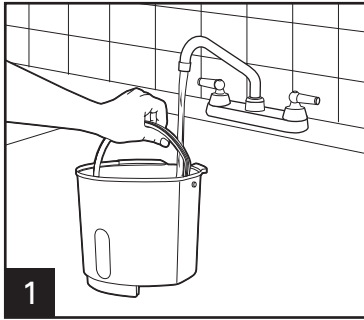

1

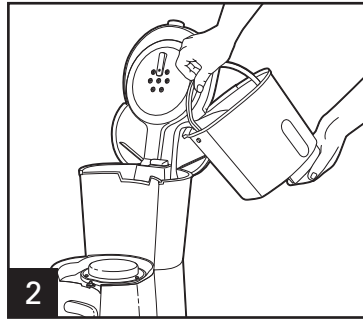

2

Normal Amount of Coffee Per Cup 1 scoop* or 3/4 tablespoon per cup		
Maximum Amount of Automatic Drip Coffee to Use in BrewStation®		
Coffee	Scoops	Tablespoons
Regular	10	8
Decaf	8	6



3

Avoid getting coffee on other areas of the unit.

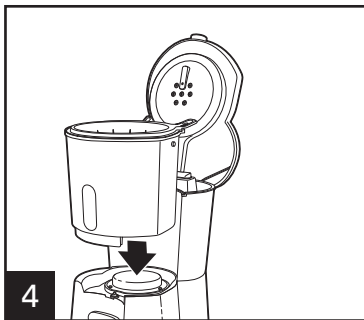

4

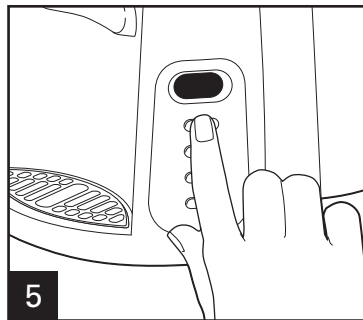

5

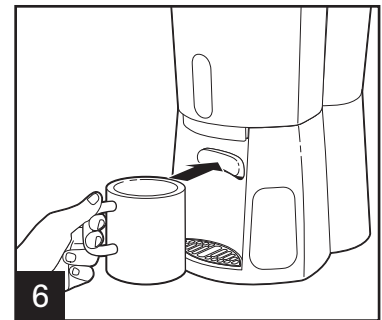

6

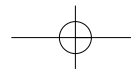
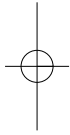

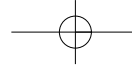

## Programming (on some models)

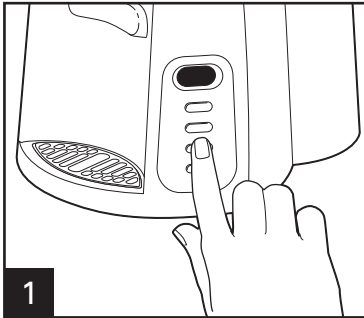

1 Press **H** and then **M** to set clock.

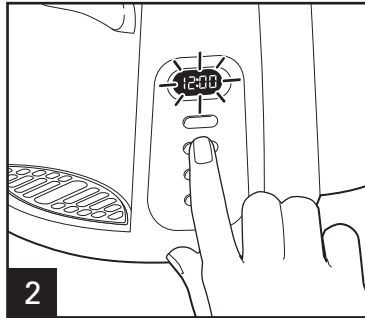

2 Hold **PROG** until clock flashes.

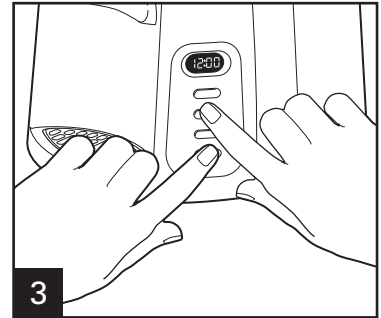

3 Continue holding **PROG** button; press **H** and **M** until the desired brewing start time is reached.



4 Press and re to activate a

## For Non-Clock Models

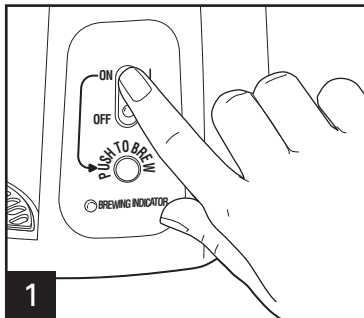

1

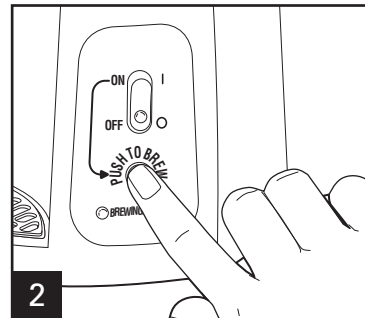

2

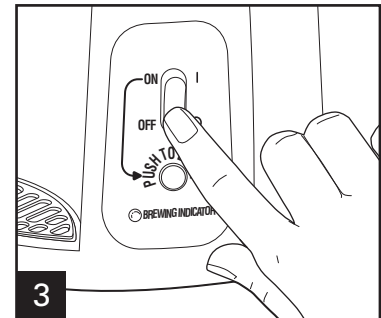

3

6

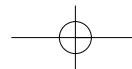

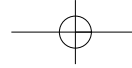

# Water Filter (optional accessory)

For better tasting coffee, use a water filter.  
Filter replacement is recommended every 60 cycles.

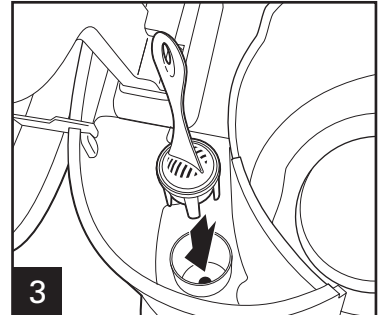
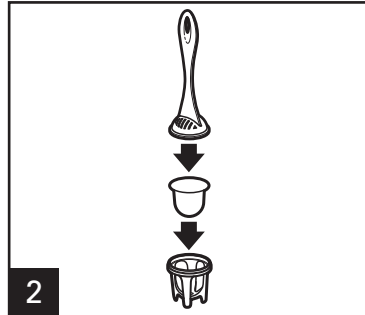
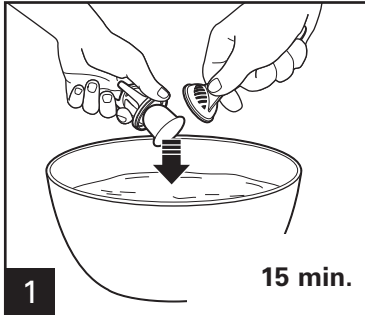

To Order  
1.800.  
1.800.2  
01.800.7  
or visit h

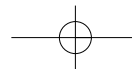
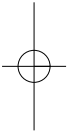



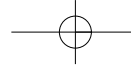

# Cleaning with Vinegar

Clean BrewStation® at least once a month (once a week for areas

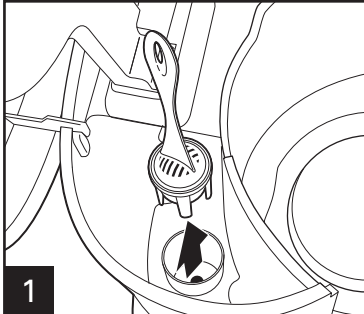

1

Remove optional water filter.



2

Pour 1 pint (2 cups/500 ml) vinegar into water reservoir.

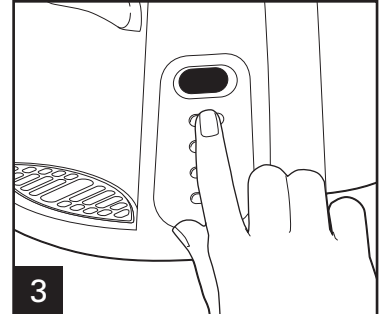

3

Press ON. Turn OFF after 20 seconds and wait 30 minutes. Press ON. Turn OFF when finished.



4

When cool, before emptying reservoir.

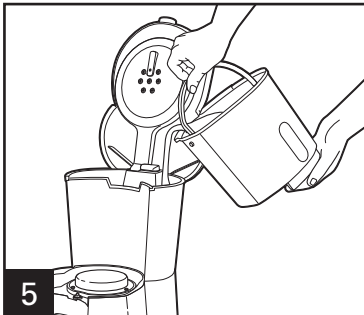

5

Run 2-3 more brew cycles with CLEAN WATER only. Allow to cool between cycles.



DISHWASHER-SAFE

## Permanent Gold Tone Filter (Optional Accessory)

The Permanent Gold Tone Filter takes the place of disposable paper filters.

Rinse in hot water before first use. Then simply place in the filter basket.

Clean under hot, running water and let dry, or place on top rack of dishwasher.

To Order Filter Call:

1.800.851.8900 (U.S.)

1.800.267.2826 (Canada)

01.800.71.16.100 (Mexico)

or visit [hamiltonbeach.com](http://hamiltonbeach.com)

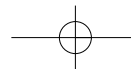

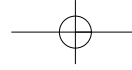

# Troubleshooting

PROBLEM	PROBABLE CAUSE
Coffee leaks from dispenser.	<ul style="list-style-type: none"> <li>Coffee grounds trapped in coffee tank dispensing mechanism under seal. See "Cleaning with Vinegar."</li> </ul>
Coffee tastes bad.	<ul style="list-style-type: none"> <li>Coffeemaker needs cleaning.</li> <li>Coffee ground too coarsely or too finely. Set to automatic drip grind.</li> <li>Coffee-to-water ratio unbalanced. Adjust for personal preference.</li> <li>Poor water quality. Use water filter or bottled water to make coffee.</li> </ul>
Coffee not brewing/coffee stops brewing/unit will not turn on.	<ul style="list-style-type: none"> <li>Mineral deposits have built up. Clean the coffeemaker following "Cleaning with Vinegar."</li> <li>Water reservoir is empty.</li> <li>Unit is unplugged.</li> <li>Power outage.</li> <li>Power surge. Unplug; then plug the unit back in.</li> </ul>
Coffee brews slowly.	<ul style="list-style-type: none"> <li><b>Coffeemaker needs cleaning.</b> Clean the coffeemaker at least every 30 days for proper performance.</li> </ul>
Coffee overflows basket.	<ul style="list-style-type: none"> <li>Excessive amounts of coffee grounds. See Table on page 5.</li> <li>Coffee ground too finely. Set to automatic drip grind.</li> <li>More than one paper filter in filter basket.</li> <li>Poor quality or wrong size paper filter.</li> <li>Coffee is decaffeinated blend. Do not exceed amount shown in Table on page 5.</li> </ul>

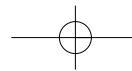

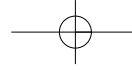

## Limited Warranty

This warranty applies to products purchased in the U.S. and Canada. This is the only express warranty for this product and any other warranty or condition.

This product is warranted to be free from defects in material and workmanship for a period of one (1) year from the purchase. During this period, your exclusive remedy is repair or replacement of this product or any component found to be defective at our option; however, you are responsible for all costs associated with returning the product to us and our return shipping charges. A replacement component under this warranty to you. If the product or component is no longer available, we will replace with a similar or greater value.

This warranty does not cover glass, filters, wear from normal use, use not in conformity with the printed directions, or damage to the product resulting from accident, alteration, abuse or misuse. This warranty extends only to the original consumer purchaser or recipient. Keep the original sales receipt, as proof of purchase is required to make a warranty claim. This warranty is intended for use for other than single-family household use.

We exclude all claims for special, incidental and consequential damages caused by breach of express or implied warranty. The amount of any award is limited to the amount of the purchase price. **Every implied warranty, including any statutory warranty or condition of sale, or fitness for a particular purpose, is disclaimed except to the extent prohibited by law, in which case such warranty shall be limited to the duration of this written warranty.** This warranty gives you specific legal rights. You may have other legal rights depending on where you live. Some states or provinces do not allow limitations on implied warranties or special, incidental or consequential damages, so the foregoing limitations may not apply to you.

To make a warranty claim, do not return this appliance to the store. Please call 1.800.851.8900 in the U.S. or 1.800.268.8900 in Canada or visit [hamiltonbeach.com](http://hamiltonbeach.com) in the US or [hamiltonbeach.ca](http://hamiltonbeach.ca) in Canada. For faster service, locate the model, type, and serial number of your appliance.

