

This Owner's Manual is provided and hosted by [Appliance Factory Parts](#).



# Bissell 1718 Owner's Manual

[Shop genuine replacement parts for Bissell 1718](#)



[Find Your Bissell Vacuum Cleaner Parts - Select From 376 Models](#)

----- Manual continues below -----



# Spot Lifter®

USER'S GUIDE

1718/1719 SERIES

3 Safety Instructions

4 Product View

5 Product Features

6-8 Operations

8-9 Maintenance and care

9-10 Troubleshooting

11 Consumer Services

11 Replacement Parts

12 Warranty



## Thanks for buying a BISSELL Spot Lifter Cordless Handheld Deep Cleaner

We're glad you purchased a BISSELL Spot Lifter cordless handheld deep cleaner. Everything we know about floor care went into the design and construction of this complete, high-tech home cleaning system.

Your Spot Lifter is well made, and we back it with a limited one-year warranty. We also stand behind it with a knowledgeable, dedicated Consumer Services department, so, should you ever have a problem, you'll receive fast, considerate assistance.

My great-grandfather invented the floor sweeper in 1876. Today, BISSELL is a global leader in the design, manufacture, and service of high quality homecare products like your Spot Lifter.

Thanks again, from all of us at BISSELL.

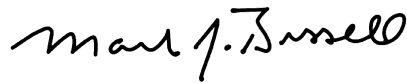

**Mark J. Bissell**  
President and Chief Executive Officer



# IMPORTANT SAFETY INSTRUCTIONS

When using an electrical appliance, basic precautions should be observed, including the following:

**READ ALL INSTRUCTIONS BEFORE USING YOUR BISSELL SPOT LIFTER CORDLESS HAND-HELD DEEP CLEANER.**

## **WARNING - To reduce the risk of fire, electric shock, or injury:**

- Store indoors.
- Do not expose to rain.
- Do not immerse.
- Do not handle with wet hands.
- Do not use Spot Lifter if it has been dropped, damaged, left outdoors or dropped into water, have it repaired at an Authorized Service Center.
- Do not use with damaged cord or plug on the charger.
- Do not unplug charger by pulling on cord.
- Do not damage the charger cord. Never carry or pull the charger unit by the cord, use cord as a handle, close door on cord, or pull cord around sharp edges or corners. Keep cord away from heated surfaces.
- Do not use an extension cord. Charger should plug directly into electrical outlet.
- Do not put any object into appliance openings, use with blocked opening, or restrict air flow.
- Do not use with any opening blocked.
- Do not expose hair, loose clothing, fingers or body parts to openings or moving parts.
- Do not pick up hot, burning or smoking objects such as cigarettes, matches or hot ashes.
- Do not pick up flammable or combustible materials (lighter fluid, gasoline, kerosene, etc.) or use in the presence of explosive liquids or vapor.
- Do not use appliance in an enclosed space filled with vapors given off by oil base paint, paint thinner, some moth proofing substances, flammable dust, or other explosive or toxic vapors.
- Do not pick up toxic material (chlorine bleach, ammonia, drain cleaner, gasoline, etc.)
- Do not allow to be used as a toy. Close attention is necessary when used by or near children.
- Do not use for any purpose other than described in this User's Guide.
- Use only manufacturer's recommended attachments - use of attachments not provided or sold by BISSELL may cause fire, electric shock or injury.
- Use only cleaning products formulated or recommended by BISSELL for this appliance.
- Use only the charger supplied by BISSELL (packaged with your appliance) to recharge your Spot Lifter.
- Use charger unit only in standard electrical outlet (120v-60 hz).
- Keep openings free of dust, lint, hair, etc.
- Unplug charger unit from outlet before maintenance or cleaning.
- Unplug by grasping the plug, not the cord.
- Be extra careful when cleaning stairs.
- Turn off all controls when finished cleaning.
- Do no charge the unit outdoors.

Your Spot Lifter contains rechargeable nickel cadmium batteries. Do not incinerate batteries or they can explode when exposed to high temperatures.

Battery cell leaks can occur under extreme conditions. If battery cell liquid comes in contact with the skin:

- Wash immediately with soap and water, then neutralize with a mild acid such as vinegar or lemon juice.
- If battery cell liquid gets into the eyes:
- Flush immediately with clean water for a minimum of 10 minutes.
- Seek medical attention.

## **SAVE THESE INSTRUCTIONS FOR FUTURE USE.**

This model is for household use only.



## Product view

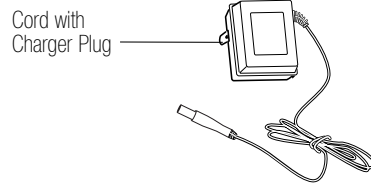
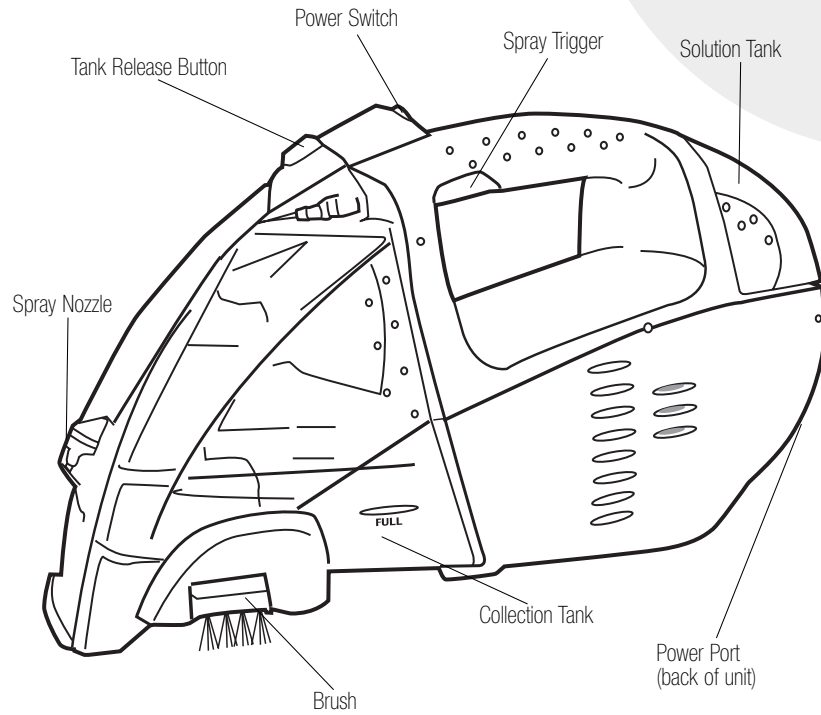

**CAUTION:** Only use one of BISSELL's advanced formulas for portable deep cleaning machines in your cleaner. Use of cleaning formulas which contain lemon or pine oil may damage this appliance and void warranty. Do not use chemical spot cleaners or solvent-based soil removers. These products may react with the plastic materials used in your cleaner, causing cracking or pitting.

## How to use this guide

This user's guide has been designed to help you get the utmost satisfaction from your Spot Lifter cordless hand-held deep cleaner. You'll find assembly directions, instructions for all cleaning tasks, safety precautions, plus maintenance and troubleshooting instructions. Please read this guide thoroughly before using your Spot Lifter. Pay particular attention to the parts diagram and part names. Familiarize yourself with the controls and how they're used. Following the guide will greatly enhance your ability to get the best performance from your Spot Lifter for many years.

## Product features

### Solution tank

Holds BISSELL Advanced Cleaning formulas for portable deep cleaning machines and water. (See Filling the solution tank," page 6)

### Collection tank

Empty after each use, or when dirty water reaches the indicated maximum fill line. (See Machine care page 8)

### Tank release button

Press to remove the collection tank.

### Power port

Connect charger cord here to charge Spot Lifter.

### Spray trigger

Press to spray cleaning solution and water.

### Standard/deluxe brush

For scrubbing stubborn spots and soil. Removable for use on or off the unit.

### Charger plug

Plugs into electrical outlet. Spot Lifter is not designed to operate while plugged in to the charger.



## Operations

### Charging the battery

1. When charging for the first time, allow to charge uninterrupted for at least 12 hours.

**NOTE: When charging, the Spot Lifter and charger may become warm to the touch. This is normal and no cause for concern.**

2. Spot Lifter must be in “**O**” (OFF) position to charge.
3. When completely charged, your Spot Lifter will operate for up to 7 minutes for model 1718 and up to 15 minutes for model 1719. When completely discharged, it will take approximately 12 hours to fully recharge.
4. To charge your Spot Lifter, connect the round end of the charger cord into the power port on the back of the unit.

**NOTE: Decreased operating time may indicate that the battery has built up a charging resistance. To recharge, first completely exhaust the battery, recharge it, then exhaust it once again before recharging a second time. This procedure may be required more than once.**

### Filling the solution tank

1. Remove solution tank by grasping it firmly and pulling straight up.
2. Unscrew and remove the cap. Add water and formula\* to the indicated fill lines on the solution tank.  
**\*Note: Your Spot Lifter includes a trial size bottle of formula.**
3. Replace cap and place solution tank back on unit.

### *Tip:*

For maximum battery life, completely discharge and recharge Spot Lifter every 1-2 months.

### *Tip:*

After unit is charged (approximately 12 hours) unplug from outlet. This will aid in prolonging the life of the battery.

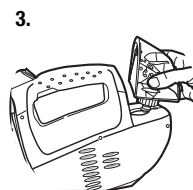
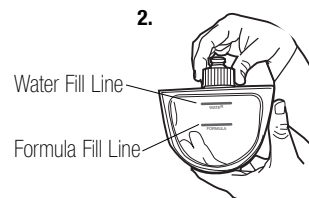
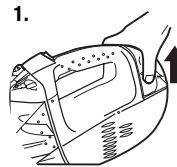

## Operations (continued)

### Pre-treating

1. Turn power switch "I" (ON).
2. To pre-treat stained or highly soiled areas, hold Spot Lifter above soiled surface and press trigger to spray cleaning solution.
3. Let cleaning solution set for 3-5 minutes before cleaning.

2.



### *Tip:*

Immediate attention to a spill on upholstery can prevent permanent staining.

### Spot cleaning carpet

1. Turn power switch "I" (ON).
2. Hold Spot Lifter above soiled surface and press trigger to spray cleaning solution, as in pre-treating step 2 above.
3. Press front of Spot Lifter firmly against surface and pull toward you to remove cleaning solution and soil.
4. Repeat steps 2 and 3 until no more dirt or cleaning solution can be removed. Do not overwet.
5. For stubborn soil, use brush to gently scrub soiled area while continuing to spray cleaning solution. To remove brush from unit, gently pull on brush tab and lift out.  
**NOTE: If Spot Lifter stops spraying, turn "O" (OFF) power switch and check cleaning solution level. Refill if needed. Never run dry.**

3.

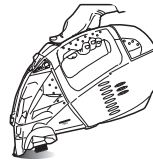

5.



### *Tip:*

Use the brush after applying cleaning solution and remove any surface soil. Using the brush before applying solution can push soil more deeply into carpet.

### Spot cleaning upholstery

1. Check manufacturer's tag before cleaning. "W" or "WS" on the tag means you can use your Spot Lifter. If tag is coded with an "S" (with diagonal strike-through), or says "Dry Clean Only," do not proceed.
2. If manufacturer's tag is missing or not coded, check with your furniture dealer.  
**NOTE: If possible, check upholstery stuffing. Colored stuffing may bleed through fabric when wet.**

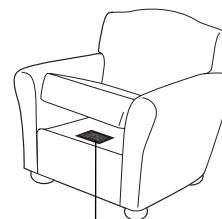

Manufacturer's Tag



## Operations (continued)

### Cleaning spills from hard surfaces

1. Turn power switch "I" (ON).
2. Press front of Spot Lifter firmly against hard surface to suction up spill.
3. Press trigger to spray cleaning solution.
4. Press front of Spot Lifter firmly against hard surface to suction cleaning solution, as in step 2 above.

**NOTE: If the Spot Lifter stops spraying, turn unit "O" (OFF) and check the cleaning solution level in the solution tank. Refill if needed. Never run the unit without water or cleaning solution.**

2.

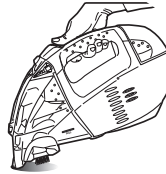

3.

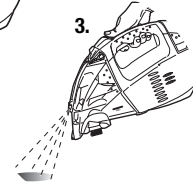

## Maintenance and care

### Machine care

1. Turn the power switch to the "OFF" position. (O)
2. Carry the Spot Lifter to the sink or drain.

### To empty the collection tank

1. Remove the collection tank by pressing the tank release button at the top of the tank. The tank will pivot out on a "hinge" at the bottom of the unit.
2. Remove the tank plug by turning approximately 1/4 turn counterclockwise and lifting out. Empty tank.
3. Thoroughly rinse the collection tank with clean water. Be sure to rinse nozzle area.
4. Replace tank plug and turn approximately 1/4 turn clockwise, until snug.
5. To replace the tank, pivot bottom of tank back into "hinge" and tilt up to handle. Press the tank release button, and snap the tank into place. Test for a secure fit before using.

**NOTE: Check the solution tank. If a significant amount of BISSELL Little Green formula/water remains, you may leave it in the solution tank for your next cleaning task.**

2.



3.

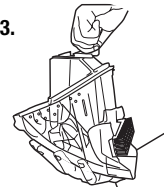

### *Tip:*

Check spray nozzle for accumulated dirt or debris. If necessary, clean with soft bristle brush.

## Maintenance and care (continued)

### Machine storage

1. Clean exterior surface of Spot Lifter with a soft cloth dampened with water only. Do not use a strong detergent or other cleaners as this may damage the finish.
2. Store Spot Lifter in a protected dry area, at room temperature (40° - 110°F).

### Battery removal and disposal

1. Important: Unplug charger.
2. Remove tanks (front and rear) and discard.
3. Remove screws (6) holding product housing together.
4. Use screwdriver to score rating label on bottom of unit.
5. Separate housings and locate battery pack in bottom/ center of unit.
6. Remove wire connectors from the battery pack.
7. Keep battery pack together - DO NOT separate individual batteries. For specific disposal instructions of batteries, please contact: RBRC (Rechargeable Battery Recycling Corporation) 1-800-822-8837.
8. Discard remainder of product.



### **WARNING:**

This product contains a rechargeable nickel cadmium battery (sometimes referred to as a "Ni-Cad" battery) pack. The average life of a Ni-Cad battery is 5-7 years, depending on frequency of use. According to Federal regulations, proper removal and disposal of Ni-Cad batteries are required.

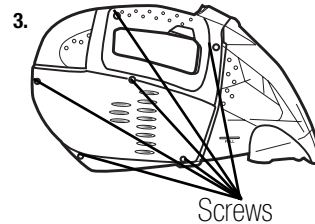

## Troubleshooting

### **Reduced Suction / No Suction**

#### **Possible Cause**

1. Collection tank is full
2. Collection tank drain plug is loose
3. Batteries weak/undercharged
4. Collection tank not properly installed

### **WARNING:**

To reduce the risk of fire, electric shock or injury, unplug appliance from outlet before servicing.

#### **Remedies**

1. Empty collection tank
2. Check plug for snug fit
3. Recharge according to instructions
4. Snap tank into place

## Troubleshooting (continued)

### Reduced Spray / No Spray

#### Possible Cause

1. Solution tank is empty
2. Pump not primed
3. Batteries weak/undercharged
4. Spray tip clogged

#### Remedies

1. Refill solution tank
2. While Spot Lifter is turned on, press spray trigger and gently rock Spot Lifter back and forth
3. Recharge according to instructions
4. Rinse tip with clean water

### Spot Lifter is not powered / underpowered

#### Possible Cause

1. Charger / plug not connected

#### Remedies

1. Make sure charger plug is completely plugged into wall outlet and charging cord is completely plugged into port on back of unit. Make sure Spot Lifter is stored with power switch in "O" (off) position

### Spot Lifter will not charge

#### Possible Cause

1. Charger / plug not connected
2. Batteries have charging resistance

#### Remedies

1. Make sure charger plug is completely plugged into wall outlet and charging cord is completely plugged into port on back of unit. Make sure Spot Lifter is stored with power switch in "O" (off) position
2. To recharge, first completely exhaust the battery, recharge it, then exhaust it once again before recharging a second time. This procedure may be required more than once.

Other Maintenance or Service not included above should be performed by an authorized service representative.

**Thank you for selecting a BISSELL product.**

**Please do not return this product to the store**

**For any questions or concerns, BISSELL is happy to be of service.**

**Contact us directly at 1-800-237-7691.**



## BISSELL Consumer Services

For information about repairs or replacement parts, or questions about your warranty, call:

### BISSELL Consumer Services

**1-800-237-7691**

Monday - Friday 8 a.m. — 10 p.m. ET

Saturday 9 a.m. — 8 p.m. ET

Or write:

BISSELL HOMECARE, INC

PO Box 3606

Grand Rapids MI 49501

ATTN: Consumer Services

Or visit the BISSELL website - [www.bissell.com](http://www.bissell.com)

When contacting BISSELL, have model number of unit available.

Please record your Model Number: \_\_\_\_\_

Please record your Purchase Date: \_\_\_\_\_

**NOTE: Please keep your original sales receipt. It provides proof of date of purchase in the event of a warranty claim. See warranty information on page 12 for details.**

## Replacement Parts - BISSELL Spot Lifter

Item	Part No.	Part Name
1	203-2570	1718 Collection Tank including plug (Clear Pearl)
2	203-2571	1719 Collection Tank including plug (Lavender)
3	203-2564	1718 Solution Tank including cap & insert (Clear Pearl)
4	203-2567	1719 Solution Tank including cap & insert (Lavender)
5	203-2504	Collection Tank Plug
6	203-2575	Solution Tank Cap & Insert
7	203-2572	1718 Charger Cord
8	203-2573	1719 Charger Cord
9	203-2574	Deluxe Brush



[www.bissell.com](http://www.bissell.com)



800.237.7691

**11**

## Warranty - BISSELL Spot Lifter

This warranty gives you specific legal rights, and you may also have other rights which may vary from state to state. If you need additional instruction regarding this warranty or have questions regarding what it may cover, please contact BISSELL Consumer Services by E-mail, telephone, or regular mail as described below.

**Keep your original sales receipt — it is your proof of warranty.**

### Limited One Year Warranty

Subject to the **\*EXCEPTIONS AND EXCLUSIONS** identified below, upon receipt of the product BISSELL Homecare, Inc. will repair or replace (with new or remanufactured components or products), at BISSELL's option, free of charge from the date of purchase by the original purchaser, for one year any defective or malfunctioning part.

See information below on "If your BISSELL product should require service".

This warranty applies to product used for personal, and not commercial or rental service. This warranty does not apply to fans or routine maintenance components such as filters, belts, or brushes. Damage or malfunction caused by negligence, abuse, neglect, unauthorized repair, or any other use not in accordance with the User's Guide is not covered.

### If your BISSELL product should require service:

Contact BISSELL Consumer Services to locate a BISSELL Authorized Service Center in your area.

If you need information about repairs or replacement parts, or if you have questions about your warranty, contact BISSELL Consumer Services.

#### Website or E-mail:

[www.bissell.com](http://www.bissell.com)

Use the "Customer Service" tab.

#### Or Call:

BISSELL Consumer Services

1-800-237-7691

Monday - Friday 8 a.m. - 10 p.m. ET

Saturday 9 a.m. - 8 p.m. ET

#### Or Write:

BISSELL Homecare, Inc.

PO Box 3606

Grand Rapids MI 49501

ATTN: Consumer Services

**BISSELL HOMECARE, INC. IS NOT LIABLE FOR INCIDENTAL OR CONSEQUENTIAL DAMAGES OF ANY NATURE ASSOCIATED WITH THE USE OF THIS PRODUCT. BISSELL'S LIABILITY WILL NOT EXCEED THE PURCHASE PRICE OF THE PRODUCT.**

**Some states do not allow the exclusion or limitation of incidental or consequential damages, so the above limitation or exclusion may not apply to you.**

**\*EXCEPTIONS AND EXCLUSIONS FROM THE TERMS OF THE LIMITED WARRANTY  
THIS WARRANTY IS EXCLUSIVE AND IN LIEU OF ANY OTHER WARRANTIES  
EITHER ORAL OR WRITTEN. ANY IMPLIED WARRANTIES WHICH MAY ARISE BY  
OPERATION OF LAW, INCLUDING THE IMPLIED WARRANTIES OF MERCHANTABILITY  
AND FITNESS FOR A PARTICULAR PURPOSE, ARE LIMITED TO THE ONE YEAR  
DURATION FROM THE DATE OF PURCHASE AS DESCRIBED ABOVE.**

**Some states do not allow limitations on how long an implied warranty lasts, so the above limitation may not apply to you.**



©2006 BISSELL Homecare, Inc.  
Grand Rapids, Michigan  
All rights reserved. Printed in China  
Part Number 603-5410  
Rev 8/06  
Visit our website at:  
[www.bissell.com](http://www.bissell.com)  
Scotchgard is a trademark of 3M

