

SEA BREEZE 24H43ZCX Owner's Manual

[Shop genuine replacement parts for SEA BREEZE
24H43ZCX](#)

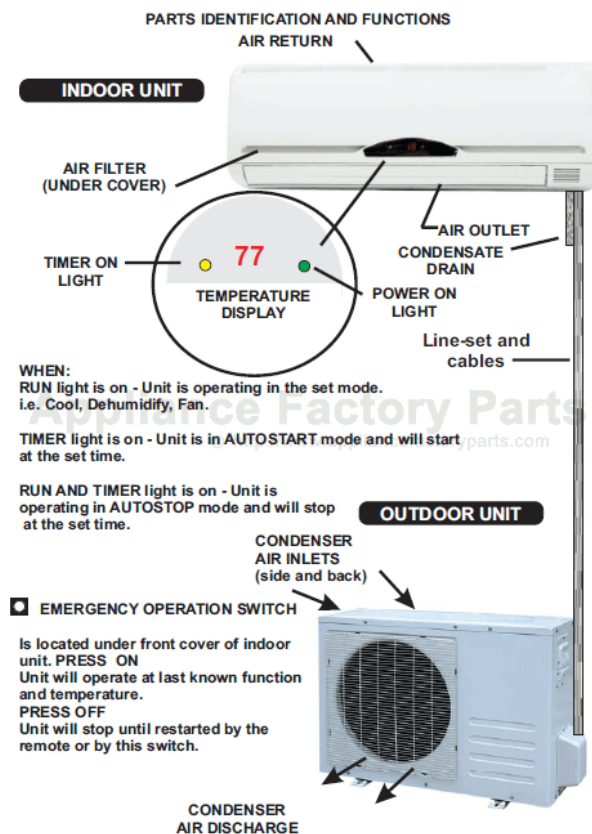

[Find Your SEA BREEZE Air Conditioner Parts - Select From 23 Models](#)

----- Manual continues below -----



OPERATING INSTRUCTIONS FOR MINI-SPLIT AIR CONDITIONING SYSTEM

MODEL

24A43ZCX

TABLE OF CONTENTS

USER INSTRUCTIONS.....

PARTS IDENTIFICATION.....

REMOTE CONTROL OPERATION AND INDICATORS.....

MAINTENANCE.....

TROUBLESHOOTING.....

WARRANTY.....

TECHNICAL ASSISTANCE.....

USER INSTRUCTIONS AND INFORMATION

In this manual, you will find safety information for installation and operation. For your safety and the safety of others, read all cautions located throughout this manual.

WARNINGS AND CAUTIONS



WARNING

This symbol refers to a hazard or unsafe practice which can result in severe personal injury or death.



CAUTION

This symbol refers to a hazard or unsafe practice which can result in personal injury or property damage.

Please read the instruction manual prior to use to ensure proper operation of your unit.

INSTALLATION

These units are not designed to be installed in the following locations:

In areas where there is a possibility of combustible gases or fumes.

In damp or moist areas.

Always use proper size breaker or fuse. Failure to do so may cause fire.

OPERATION

Always turn the unit to the "OFF" mode with the remote control. Never use a circuit breaker or fuse as a means of turning the unit off, except in the case of an emergency.

Do not operate this unit if you are wet or have wet hands. Electric shock can occur.

Do not spray insecticides, paints, or other flammable sprays or liquids into or around the unit.

Do not put foreign objects into the unit.

Do not hang or place items on the unit.

Do not use harsh chemicals such as paint thinner, benzene, or polish to clean the unit.

During cooling operation, shades, blinds, and curtains should be used to shade the room from direct sunlight.

PARTS IDENTIFICATION AND FUNCTIONS

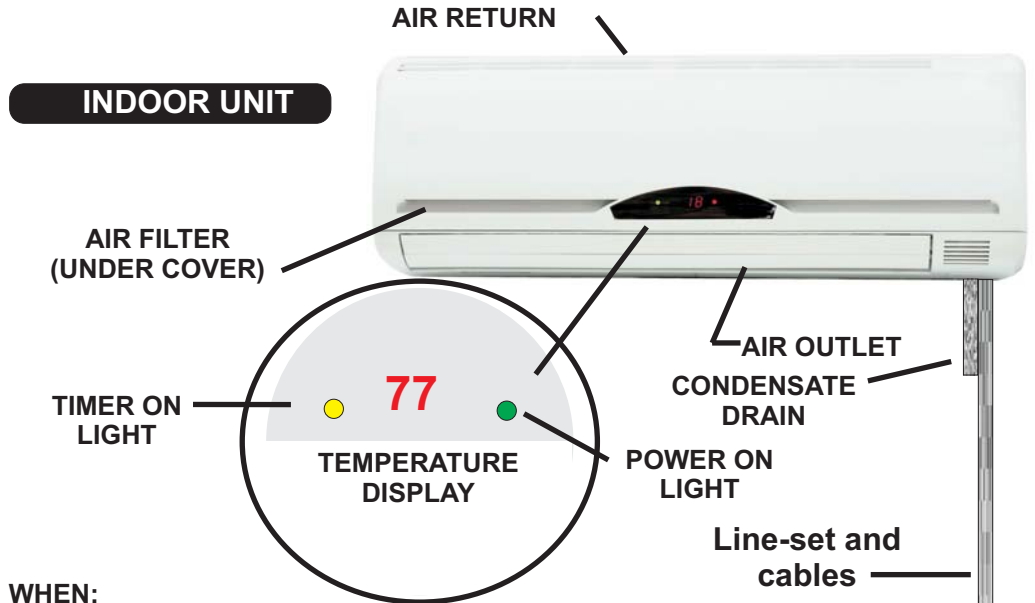

WHEN:
RUN light is on - Unit is operating in the set mode.
i.e. Cool, Dehumidify, Fan.

TIMER light is on - Unit is in AUTOSTART mode and will start at the set time.

RUN AND TIMER light is on - Unit is operating in AUTOSTOP mode and will stop at the set time.

OUTDOOR UNIT

EMERGENCY OPERATION SWITCH

Is located under front cover of indoor unit. **PRESS ON**
Unit will operate at last known function and temperature.
PRESS OFF
Unit will stop until restarted by the remote or by this switch.

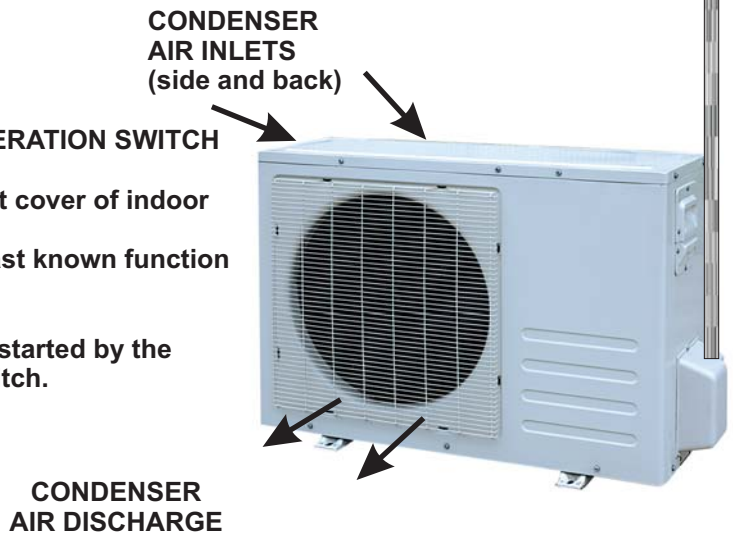

TO OPEN FRONT COVER

Press inward on the sides of the cover near the bottom to release, then pull bottom of cover outwards

To close the cover, press the corners inward to latch. **DO NOT OVEREXTEND THE FRONT COVER.**

REMOTE CONTROL OPERATION

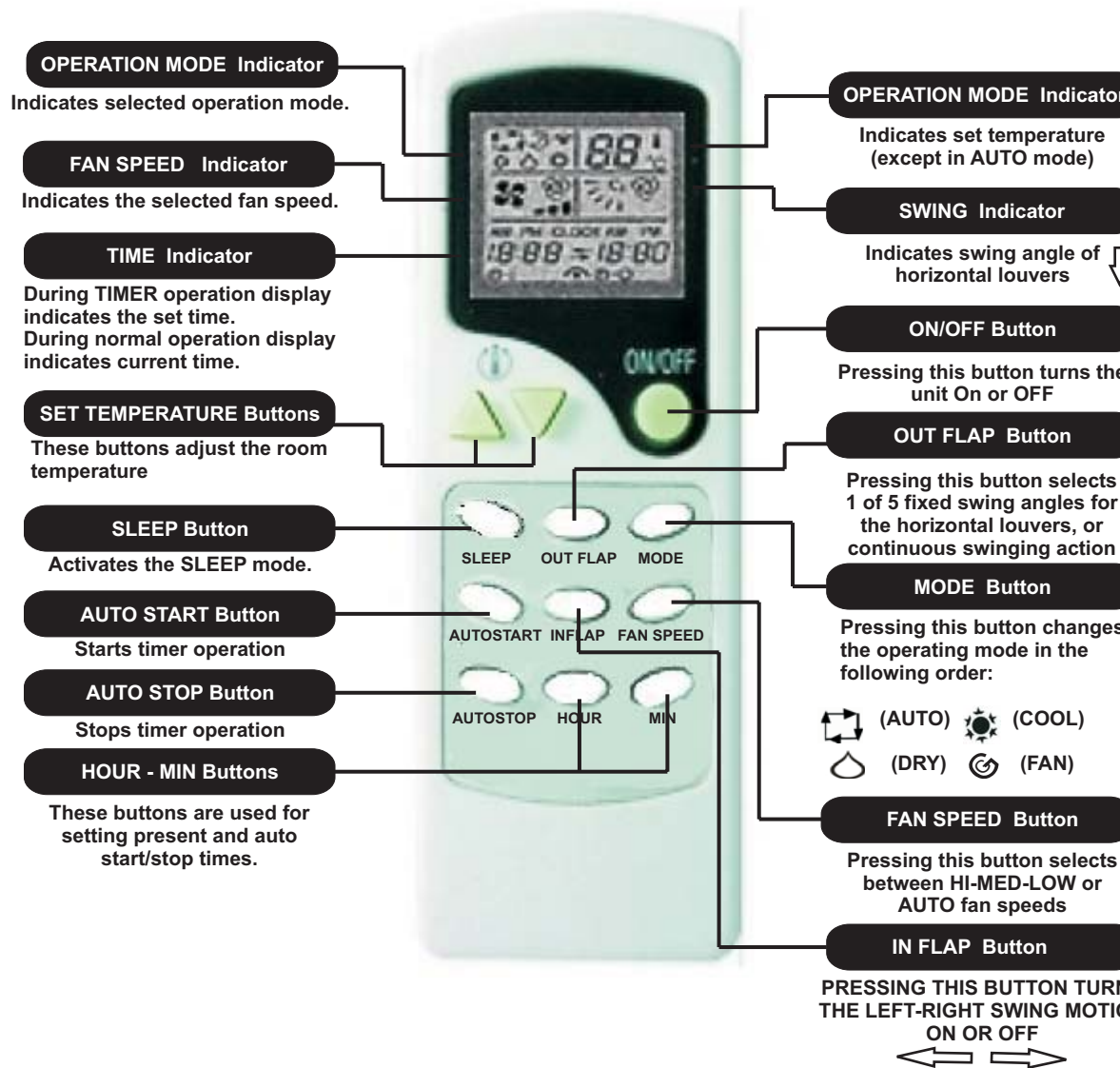

NOTE: When changing functions, please allow 3 - 4 minutes for the condensor unit to restart.

USE OF THE REMOTE CONTROL (AUTO SELECT MODE)



USE OF THE REMOTE CONTROL (DEHUMIDIFY)

In the AUTOSELECT mode, the system functions as described below:

When the room temperature is below 70° F, the system will function in the FAN mode.

When the room temperature is between 70° F and 79° F, the system will function in the DEHUMIDIFY mode.

When the room temperature is above 79° F, the system will function in the COOLING mode.

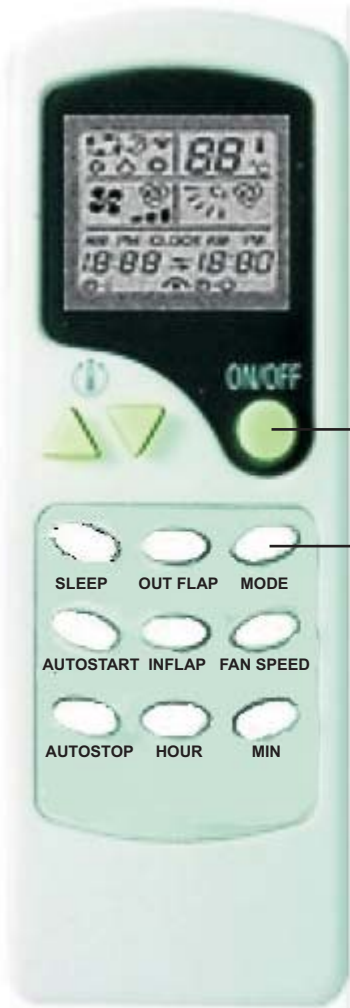

1) Press the ON/OFF Button to turn the unit ON

2) Press the MODE Button and select the AUTO mode.

3) Press the ON/OFF Button or select another mode to stop the AUTO mode.

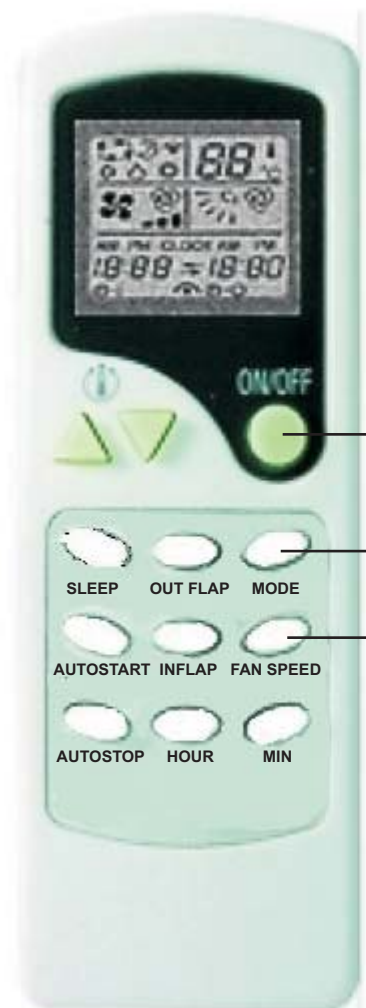

During the outdoor evaporator the "s" temperature

Temp du

1) P

2) and

3) B
Bu
fan

4) F
or
stop

USE OF THE REMOTE CONTROL (COOL MODE) 

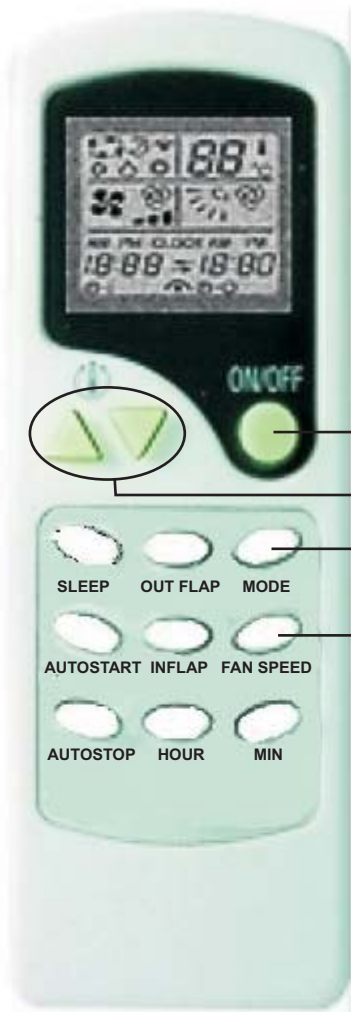

The COOL mode activates the outdoor compressor as necessary to satisfy the selected room temperature.

- 1) Press the ON/OFF Button to turn the unit ON
- 2) Press the MODE Button and select the COOL Mode
- 3) Press the + or - Buttons to adjust the room temperature. Each press of the button will change the temperature 1°
- 4) Press the FAN SPEED Button to select the desired fan speed
- 5) Press the ON/OFF Button or select another mode to stop the COOL mode.

USE OF THE REMOTE CONTROL (FAN MODE)

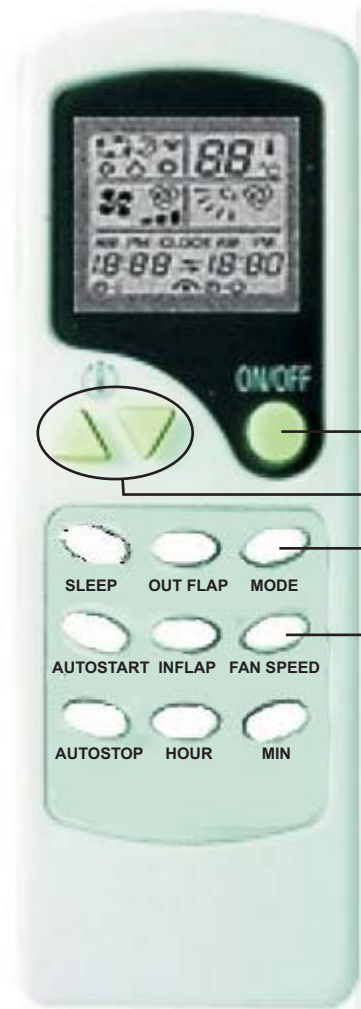

NOTE: in fan mode, the compressor will not run. The room temperature will not change. The fan will only run if the room temperature is above the set temperature.

- 1) Press the ON/OFF Button to turn the unit ON
- 2) Press the MODE Button and select the FAN Mode
- 3) Press the +/- Buttons to adjust the fan speed. Each press of the button will change the fan speed.
- 4) Press the ON/OFF Button to stop the fan speed.
- 5) Press the MODE Button or select another mode to stop the FAN mode.





In the SLEEP mode, the system lowers the fan speed, and raises the setpoint temperature slightly.

1) Press the SLEEP Button to change to the sleep mode (quiet operation)

2) Press the SLEEP Button again to return to normal operation.

NOTE: Pressing the FAN SPEED button during SLEEP mode will cancel the sleep mode.



1) Remove the battery cover on the back of the remote

CLK Button (to set clock)

2). Use a ball point pen or similar device, press this button one time

3). Press the HOUR button to set the hours

4). Press the MIN button to set the minutes.

5.) Press the CLK button again to lock in set time.

6). Replace the battery cover by sliding it back on

Replace batteries with AAA cells. Observe polarity.

USE OF THE REMOTE CONTROL (AUTOSTART MODE)

USE OF THE REMOTE CONTROL (AUTOSTART MODE)

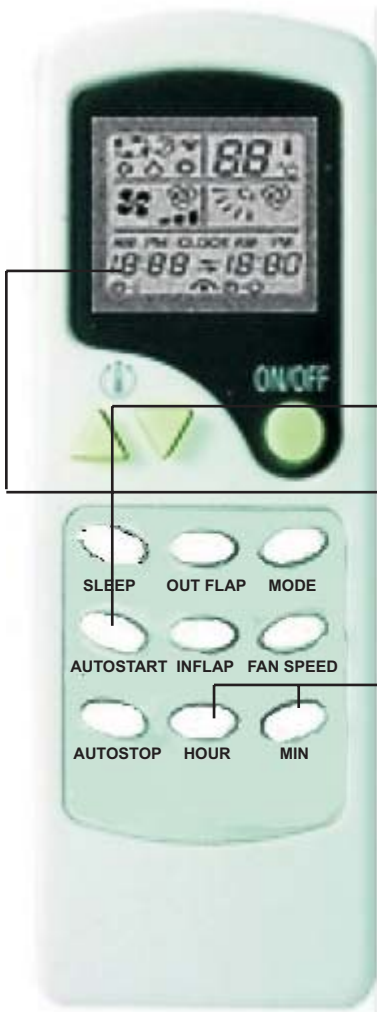

The Autostart function will start the unit in the last selected mode. The Autostart function will turn the unit ON when the selected time is reached. During the "ON" period, modes, fan speeds, and temperatures may be adjusted. If the unit is "ON" when AUTOSTART is selected, it will turn OFF until the selected time is reached.

1). Press the AUTOSTART button to set the TURN ON timer

2). The clock will display the turn on time.

3). Press the HOUR and MIN buttons to set the turn on time. Each time the HOUR button is pressed will increment the time by 1 hour. Each time the MIN button is pressed will increment the time by 10 minutes.

4.) Press the AUTOSTART button again will release the timer.

NOTE: The clock must be set in order for the AUTOSTART mode to function properly

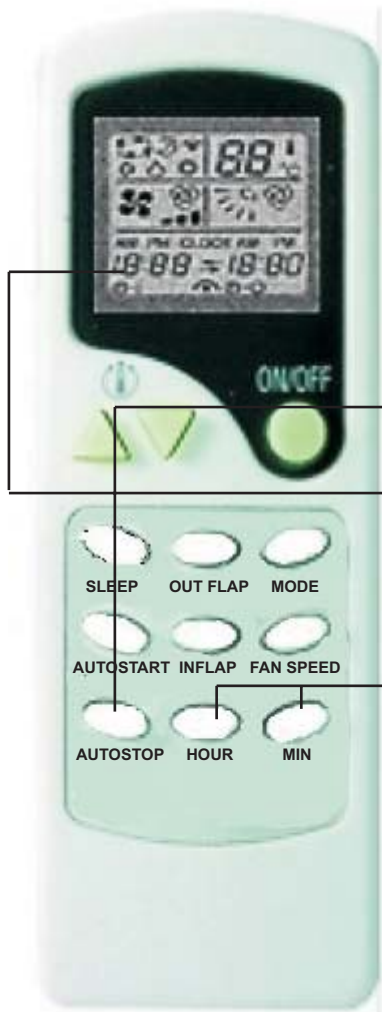

Th
Th
U

1
to

2

3).
pr
1 h
pr

4

NO
ord

NOTE: The AUTOSTART and AUTOSTOP timers can be used in combination with each other. For example, to have the unit come on and run for 3 hours beginning at 10:00 am set the AUTOSTART time to 10:00 am, and set the AUTOSTOP time to 1:00 pm. At 10:00 am, the unit will turn on in the selected modes, and turn off at 1:00 pm. The timer which is set to the earliest time will activate first. For example, if AUTOSTOP is set for 10:00 am and AUTOSTART is set for 11:00 am, the unit will turn off at 10:00 am. The time settings will remain in memory of the remote until changed, but AUTOSTART and/or AUTOSTOP are not recurring events, and must be set again if desired. Pressing the AUTOSTART button or the AUTOSTOP button during the set time period will cancel that operation.

LOUVER ADJUSTMENTS (Air Flow Direction)



By positioning the OUTFLAP and INFLAP, you may direct the airflow to maximize the cooling effectiveness

1) Press the ON/OFF Button to turn the unit ON

2) Press the MODE Button and select the desired mode (AUTO, COOL, DRY, or FAN)

3) Press the OUTFLAP Button to select the desired angle of the outer horizontal louvers. The horizontal louvers control the vertical air flow ↓ ↑ from the unit. There are 5 stationary angles, and the last position is continuous swing of the horizontal louvers.

4) Press the FAN SPEED Button to select the desired fan speed

5) Press the INFLAP Button to select the desired action of the vertical louvers. The vertical louvers control the horizontal air flow from the unit. The vertical louvers either direct the air straight out of the unit, or they swing left to right continuously.

NOTE: in the cooling operation with the OUT FLAP blowing down (4th & 5th positions), the outer horizontal louvers will return to the level (position 1) after 1 hour in order to prevent condensate water from dripping.

MAINTENANCE OF YOUR UNIT

Beginning of Season

PRIOR TO OPERATION

- Carefully inspect both indoor and outdoor unit for blockages of the inlet and outlet exhaust vents.
- Inspect ground connection. Ensure that ground wire is properly connected.
- Inspect Air Filters and clean if necessary.
- Install new batteries in the remote control unit (2 ea “AAA”).

During the Season

CLEANING THE AIR FILTERS

- Filters should be cleaned every 2 weeks or more often if the unit is used continuously or the unit is operated in a high dust area.

TO REMOVE THE AIR FILTERS:

- To open the indoor unit, pressing on the outside edges of the lower corners of the cover and pull outwards. The front cover will swing upwards. **DO NOT OPEN FRONT COVER FURTHER THAN STOPS. DO NOT FORCE THE FRONT COVER OPEN.**
- To remove the filters, push the filter upwards from the bottom to release.
- Clean the filters by washing in lukewarm water (about 86°F). Allow the filters to dry before re-installing. **DO NOT USE HOT WATER. DO NOT USE HARSH CHEMICALS.**
- Re-install clean filters by sliding the filter in at the top then locking behind tabs on the bottom.
- **DO NOT OPERATE THE UNIT WITHOUT THE FILTERS IN PLACE. DAMAGE TO THE UNIT COULD OCCUR.**

NOTICE: Performance of this unit is greatly reduced when operated with dirty, damaged, or clogged filters.

AFTER THE OPERATING SEASON

- Set the temperature to 86°F and operate the unit in the FAN MODE for about 4 - 6 hours to thoroughly remove any moisture from the interior of the unit.

- Turn the unit off. In the OFF mode about 5 watts of power. If you wish to turn off the breaker to the unit.
- Clean and re-install the air filters.
- Clean both the indoor and outdoor units.
- Remove the batteries from the remote control in a safe place.

TROUBLESHOOTING

If you have a problem with your unit, please check the following items **BEFORE** calling for service:

	If the unit is not operating
Is there power at the unit	Is the remote control operating
Check for tripped breaker or blown fuse Turn breaker off for 30 seconds then turn on.	Point remote control at unit and press the power button. You should hear a “BEEP” if the unit is receiving signal from the remote. Replace batteries in remote.

	If the unit will not operate but the fan is running in cool mode
Is there remote set properly	Is there air flow
Set temperature lower than current room temperature. Verify that unit is in “COOL” mode. Unit takes 3 minutes to restart after shutdown.	Check for clogged filter. Check for blocked intake or outlet. Check fan motor.

WARRANTY

SEA BREEZE warrants the accompanying split air conditioner system to be free of defects in material and workmanship for the applications specified in the operation manual and installation manual for a period of (1) year on parts and five (5) years on the compressor, valid from date of original retail purchase in the United States or Canada.

LABOR is not covered under warranty.

If the unit exhibits a defect in normal use and it is determined to be within the warranty period, SEA BREEZE will, at its option, either repair or replace the unit free of charge within a reasonable time after the unit is returned.

This warranty DOES NOT cover:

- Damage, accidental or otherwise, to the unit while in possession of the consumer that is not a result of a defect in material or workmanship.
- Damaged caused by consumer misuse, tampering, or failure to follow all care and maintenance instructions in the manual.
- Damage to the finish of the case or other parts caused by water.
- Damage caused by repairs or alterations to the unit by anyone other than a qualified technician.
- Air Filters
- Freight and insurance cost for the warranty service.

Warranty Activation Card must be completed and sent in to activate the warranty for the accompanying unit.

TECHNICAL ASSISTANCE

IF YOU STILL NEED SERVICE:

Please contact the installation contractor, or Refrigeration Products at (704) 504-8590 between 7:30 a.m. and 4:00 p.m. E.S.T. , Monday through Friday.

For faster service, please have the model number and serial number of both the inside unit and the outside unit available.