

This Owner's Manual is provided and hosted by [Appliance Factory Parts](http://Appliance Factory Parts).



# MAJESTIC 400BBVA Owner's Manual

**[Shop genuine replacement parts for MAJESTIC  
400BBVA](#)**

FIREBOX COMPONENTS

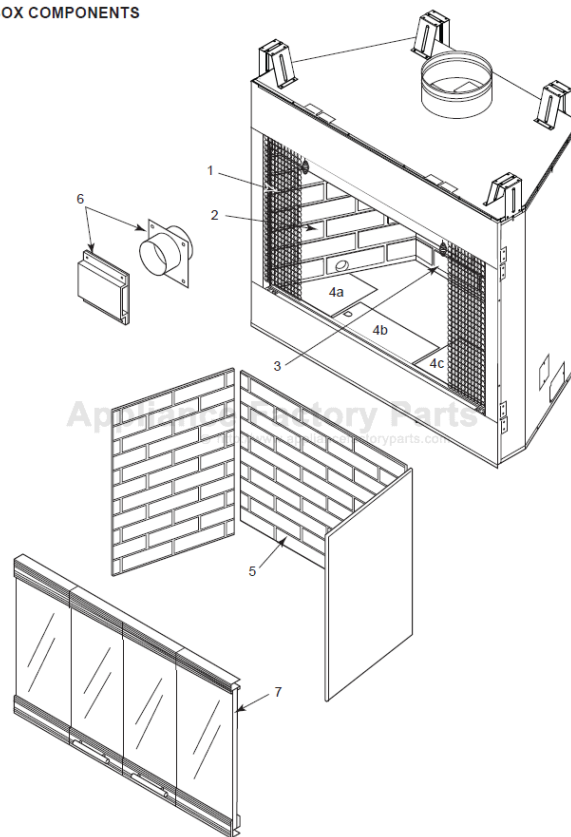

**[Find Your MAJESTIC Fireplace Parts - Select From 585 Models](#)**

----- Manual continues below -----



B Vent Fireplaces

MAJESTIC 



## B Vent Fireplace Systems

Easily incorporated into any design requirement where the fireplace can be vented straight up and out, adding the beauty and elegance of fire to your home is simple with the B vent fireplace systems from Majestic. The BBV Series offers a 36 inch radiant design with a true 36 inch brick to brick opening that has the largest viewing area in the industry. With 22,000 BTU's, optional bi-fold and single pane glass doors, and a slim 14 inch deep design, these B vent fireplaces from Majestic are a perfect choice for just about anywhere.

With 36 and 42 inch sizes, the SBV Series of B vent fireplace systems from Majestic also offer an expansive view. Both sizes come with standard refractory brick and a Black firescreen. With an impressive BTU range from 29,000 to 31,000, the SBV Series are ideal choices for hard to heat rooms.



400BBVA with Brass louvers and Tavern Brown firebrick

Give people a place to gather – make fire the focal point of your room again with our B vent fireplace systems from Majestic.



500SBVA with optional bi-fold glass doors and Polished Brass finish



400SBVA with optional bi-fold glass doors and Black finish



BVPN Designer Peninsula

## B Vent Designer Fireplace Systems

The B vent Designer Series of fireplace systems from Majestic offer sophisticated options for today's more contemporary homes. Available in See-Thru and Peninsula models, the Designer Series takes fire to a whole new level.

The radiant design allows materials to be placed right up to the edge of the firebox and with optional firebrick backs and sides as well as standard Black trim, these 42,000 BTU fireplaces offer great heating ability and exciting design applications.

### STANDARD FEATURES:

- Glowing ceramic fiber logs featuring a patented Natural Flame aluminized pan burner with random dancing flames and large ember bed
- Millivolt System with on/off switch and variable flame height control in natural gas
- Propane field convertible
- Flexible connector with On/Off valve included
- Includes 15' of preinstalled millivolt wire with wall switch and cover
- Junction box included for electrical hook up

### BBV:

- 36" radiant face unit 14" in depth
- Three piece log set with 22,000 BTU
- Available with 4" B-vent outlet

### SBV:

- 36" & 42" radiant face design units 21" in depth
- Three piece ceramic fiber log sets with 29,000 BTU in 400SBV and 31,500 BTU in 500SBV
- Shipped with refractory brick standard for true masonry look
- Available with 6" B-vent outlet

### DESIGNER FIREPLACES:

- Available in See-Thru & Peninsula units
- Hidden control panel allows facing material to be installed up to opening of units
- Realistic ceramic fiber log sets with 42,000 BTU
- Polished Brass door panels standard
- Available with 6" B-vent outlet

## B Vent Fireplaces

Model	400BBVA	
BTU / HR	16,000-22,000 NG	
Dimensions (Actual)	40"W x 40"H x 14"D	
Dimensions (Framing)	40 1/2"W x 40 3/4"H x 14 1/2"D	
Viewing Area	21 1/2"H x 36"W (756 sq. inches)	
Model	400SBVA	500SBVA
BTU / HR	16,500-25,000 NG	19,000-31,500 NG
Dimensions (Actual)	40"W x 40 1/2"H x 21"D	46"W x 40 1/2"H x 21"D
Dimensions (Framing)	40 1/2"W x 40 3/4"H x 21 1/2"D	46 1/2"W x 40 3/4"H x 21 1/2"D
Viewing Area	21 1/2"H x 36"W (756 sq. inches)	21 1/2"H x 42"W (882 sq. inches)
Model (Designer)	BVPN	BVST
BTU / HR	42,000 NG	42,000 NG
Dimensions (Actual)	38"W x 42 3/8"H x 24 1/8"D	38"W x 42 3/8"H x 24 1/8"D
Dimensions (Framing)	38 1/2"W x 42 1/2"H x 23 1/8"D	39"W x 42 1/2"H x 23 1/8"D
Viewing Area	22 1/4"H x 36"W (801 sq. inches)	22 1/4"H x 36"W (801 sq. inches)

## Optional Accessories

- Black, Polished Brass and Stainless Steel single panel doors for BBV & SBV fireplaces
- Black, Polished Brass and Stainless Steel bi-fold doors for BBV & SBV fireplaces
- Tavern Brown firebrick for BBV fireplace
- Firebrick back and side panels for Designer units
- Outside air kits
- Multi-functional Ambient Technologies® remote controls available for all units



Tavern Brown  
firebrick



Cottage Red  
firebrick

Thermostat ON/OFF remote control with 3-step flame height adjustment and 3-speed blower control with receiver



Touch screen hand held ON/OFF remote



Programmable wireless wall thermostat with receiver

See our Ambient Technologies® catalog for a complete line of remotes and thermostats.

For more information about MHSC and Majestic efficient and environmentally friendly products, please visit [www.majesticproducts.com](http://www.majesticproducts.com)



Tested & Listed By



Beaverton Oregon USA



# MAJESTIC



A Brand of Monessen Hearth Systems Co.  
149 Cleveland Drive, Paris, Kentucky 40361  
[www.majesticproducts.com](http://www.majesticproducts.com)

Your Majestic Dealer:

To avoid personal injury or property damage, the product described by this brochure must be installed, operated and maintained in strict compliance with the instructions packaged with the product and all applicable building or fire codes. Contact local building or fire officials about restrictions and installation inspection requirements. All photographs and drawings on this brochure are for illustrative purposes only and are not intended for, nor should they be used as a substitute for the instructions packaged with the unit. Appearance and specifications of the product are subject to change without notice. © 2010 Monessen Hearth Systems Co.

Ver.06 8808MAJ