

This Owner's Manual is provided and hosted by [Appliance Factory Parts](http://www.appliancefactoryparts.com).

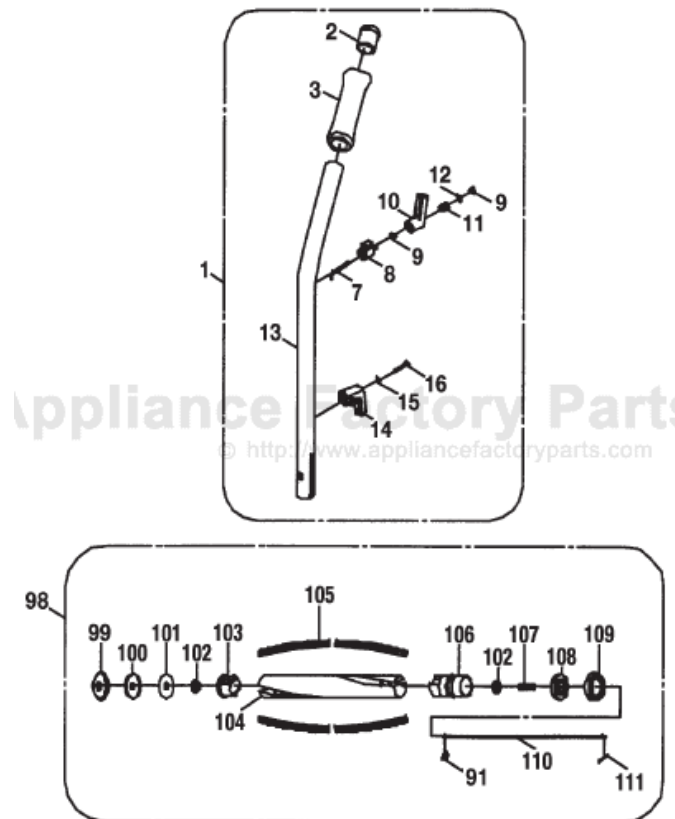

CARPET PRO CPU-2 Owner's Manual

[Shop genuine replacement parts for CARPET PRO CPU-2](#)



[Find Your CARPET PRO Vacuum Cleaner Parts - Select From 12 Models](#)

----- Manual continues below -----

CARPET · P R O

OPERATING INSTRUCTIONS

FOR CARPET PRO HEAVY DUTY
UPRIGHT VACUUMS

MODELS :

CPU-1

CPU-2

CPU-1T

CPU-2T



Before operating the vacuum,
please read these instructions completely.

Index

Important Safety Instructions	2
Two-Wire Polarization	3
Grounding Instructions	3
Parts Identification	4
Replacement Bags/Filters	4
How to Assemble and Operate the Vacuum	5
How to Change the Vacuum Bag	5
Handle Adjustments	6
How to Change the Filters	6
Edge Cleaning Feature	6
Automatic Self-Adjusting Nozzle	7
Optional Cleaning Tools/Accessories	7
How to Replace the Vacuum Belt and Headlight Bulb	8
How to Clean the Nozzle Hose	9
Thermal Fuse Protection	10
For Best Performance	10

Customer's Record

The model and serial numbers of this product may be found on the back side of the unit. You should complete the enclosed warranty card and mail it back to us as soon as possible for your protection. Also, note the model and serial numbers of your unit in the spaces provided below, and retain this book as a permanent record of your purchase.

Model Number: _____
Serial Number: _____
Date Purchased: _____

Your Carpet Pro vacuum cleaner is a product of high quality materials and superior workmanship. We urge you to read these operating instructions carefully before you use this vacuum cleaner, in order to obtain the full performance and satisfaction it can offer you.

Save These Instructions

Before you plug in your Carpet Pro vacuum cleaner, make sure the voltage indicated on the rating plate located on the backside of the vacuum cleaner is the same as your local supply.

IMPORTANT SAFETY INSTRUCTIONS

READ ALL INSTRUCTIONS BEFORE USING THIS APPLIANCE.

This machine is not intended for use by persons (including children) with reduced physical, sensory or mental capabilities, or lack of experience and knowledge, unless they have been given supervision or instruction concerning use of the machine by a person responsible for their safety. When using an electrical appliance, basic precautions should always be followed, including the following:

SAVE THESE INSTRUCTIONS.

WARNING! To reduce the risk of fire, electric shock, or injury:

1. Do not leave appliance unattended when plugged in. Unplug from outlet when not in use and before servicing.
2. **WARNING: ELECTRIC SHOCK COULD OCCUR IF USED OUTDOORS OR ON WET SURFACES.**
3. Do not allow to be used as a toy. Keep children and unauthorized persons away from the machine when in use.
4. Use only as described in this manual. Use only manufacturer's recommended attachments.
5. Do not use with damaged cord or plug. If appliance is not working as it should, has been dropped, damaged, left outdoors, or dropped into water, return it to a service center.
6. **WARNING -** The replacement or repair of damaged wiring should only be performed by a qualified electrician or service engineer from the original distributor or authorized service agent.
7. Do not pull or carry by cord, use cord as a handle, close a door on cord, or pull cord around sharp edges or corners. Do not run appliance over cord. Keep cord away from heated surfaces.
8. Do not unplug by pulling on cord. To unplug, grasp the plug, not the cord.
9. Do not handle plug or appliance with wet hands.
10. Turn off all controls before unplugging.
11. Do not put any object into openings. Do not use with any opening blocked; keep free of dust, lint, hair and anything that may reduce air flow.
12. Keep hair, loose clothing, fingers and all parts of body away from openings and moving parts.
13. Do not pick up anything that is burning or smoking, such as cigarettes, matches or hot ashes.
14. Do not use without vacuum bag and/or filters in place.
15. Use extra care when cleaning on stairs.
16. Do not use to pick up flammable or combustible liquids such as gasoline or use in areas where they may be present.
17. Do not attempt to service the unit while appliance is plugged in.
18. For grounded models, connect to a properly grounded outlet only. See Grounding Instructions.
19. This machine is not intended for use by persons (including children) with reduced physical, sensory or mental capabilities, or lack of experience and knowledge, unless they have been given supervision or instruction concerning use of the machine by a person responsible for their safety.
Keep children and unauthorized persons away from the machine when in use.

Two-Wire Polarized Cord

MODELS CPU-1 and CPU-1T

This product is equipped with a polarized alternating current line plug (a plug having one blade wider than the other). This plug will fit into the power outlet only one way. This is a safety feature. If you are unable to insert the plug fully into the outlet, try reversing the plug. If the plug should still fail to fit, contact an electrician to replace the obsolete outlet. Do not defeat the safety purpose of the polarized plug.

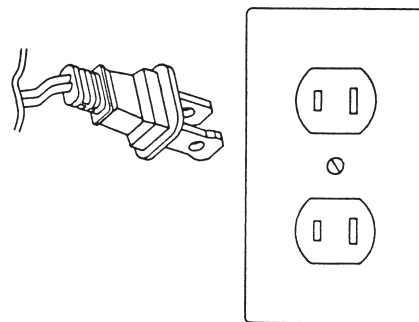

Grounding Instructions

MODELS CPU-2 and CPU-2T

This appliance must be grounded. If it should malfunction or break down, grounding provides a path of least resistance for electric current to reduce the risk of electric shock. This appliance is equipped with a cord having an equipment-grounding conductor and grounding plug. The plug must be plugged into an appropriate outlet that is properly installed and grounded in accordance with all local codes and ordinances.

This appliance is for use on a nominal 120 volt circuit and has a grounding attachment plug that looks like the plug illustrated in Fig. 1. Make sure that the appliance is connected to an outlet having the same configuration as the plug. No adapter should be used with this appliance.

WARNING - Improper connection of the equipment-grounding conductor can result in a risk of electric shock. Check with a qualified electrician or service person if you are in doubt as to whether the outlet is properly grounded. Do not modify the plug provided with the appliance. If it will not fit the outlet, have a proper outlet installed by a qualified electrician.

The replacement or repair of damaged wiring should only be performed by a qualified electrician or service engineer from the original distributor or authorized service agent

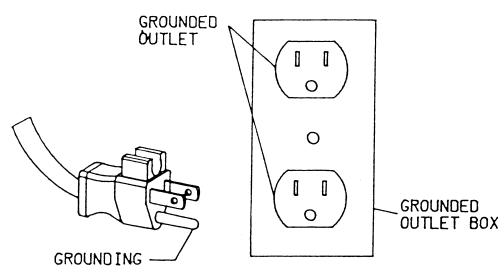
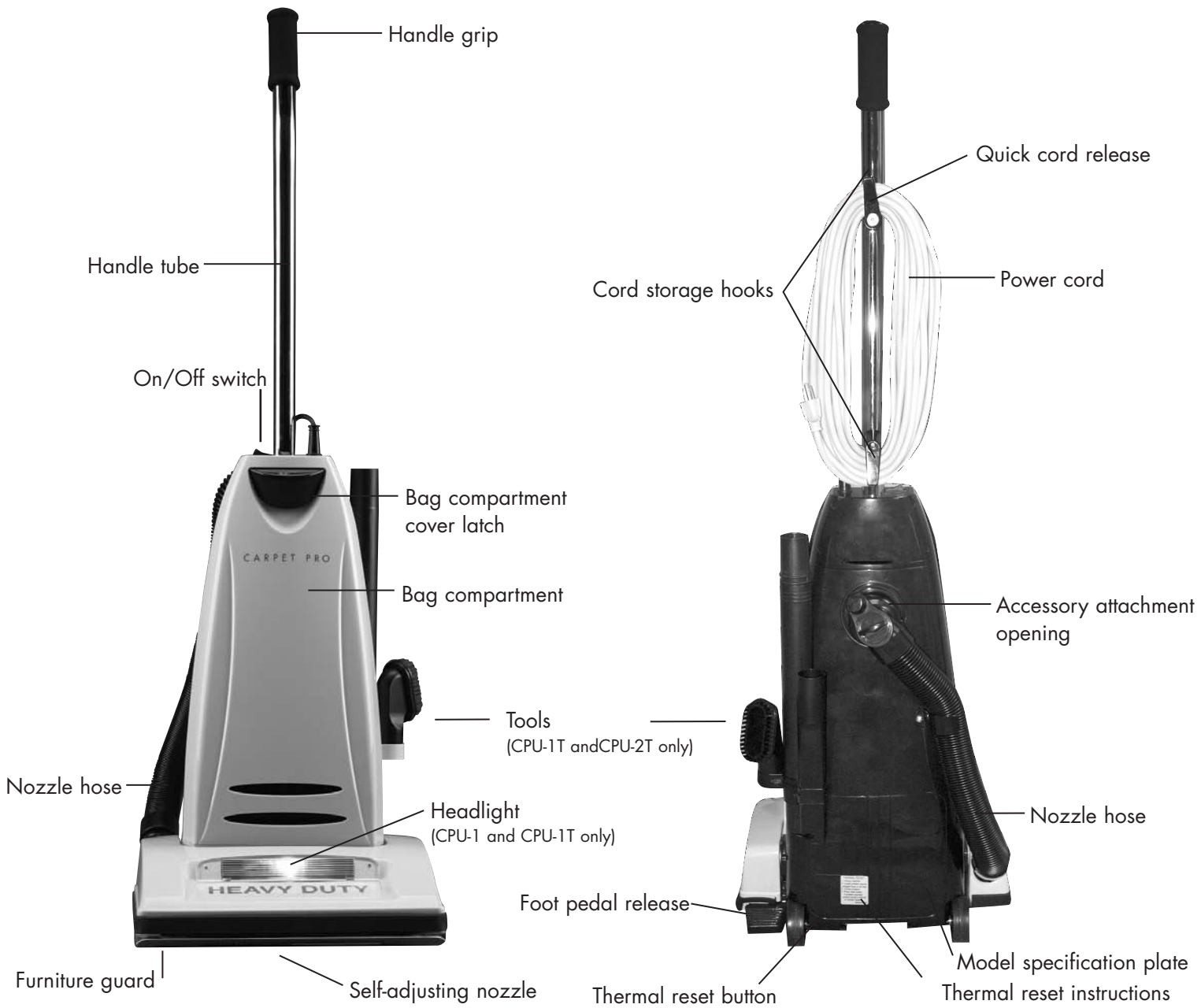

Fig. 1

Parts Identification



Replacement Bags/Filters

- Genuine Carpet Pro Vacuum Bags
Part # 06.153
3 pk.
- Genuine Carpet Pro Post Filter
Part # 06.812
1 pk.

- Genuine Carpet Pro Electrostatic Filter (CPU-1 model only)
Part # 06.317
1 pk.
- Genuine Carpet Pro Secondary Filter
Part # 06.611
1 pk.

How to Assemble and Operate the Vacuum

How to Attach the Handle to the Vacuum Cleaner

The vacuum cleaner and the handle are packed separately.

1. After first removing the handle screw, insert handle into the hole on top of the vacuum cleaner. Make sure that the cord hooks on the handle are positioned to the back of the vacuum cleaner (Fig. 1).
2. Line up the small hole on the handle with the small hole on the vacuum cleaner and insert the screw. Make sure the screw is tightened securely.
3. Turn the upper cord storage hook to the upright position and wind the power cord around the cord storage hooks when storing the vacuum cleaner (Fig. 2).



Fig. 1



Fig. 2

How to Release the Power Cord

1. The upper cord storage hook has a quick-release action. To release the cord, rotate the hook downward and the cord will drop off the handle for immediate use (Fig. 3).
2. Return the hook to the upright position before attempting to rewind the cord.



Fig. 3



Fig. 4

On/Off Switch (Fig. 4)

1. To turn the vacuum on, push the switch located on the dust compartment to the (I) position.
2. To turn the vacuum off, push the switch located on the dust compartment on the (0) position.

How to Change the Vacuum Bag

Always operate the vacuum cleaner with a vacuum bag installed.

How to Change the Vacuum Bag

1. Unplug the vacuum cleaner. Remove the bag compartment cover and remove the used bag from the bag holder (Fig. 1).
2. Attach the new vacuum bag onto the bag holder (Fig. 2).
3. Pull the bottom corners of the new vacuum bag (Fig. 3).
4. Reinsert the tab on the end of the bag compartment cover into the groove on the bag compartment housing. Press it into place and fasten the bag compartment cover latch tightly (Fig. 4).



Fig. 1



Fig. 2



Fig. 3



Fig. 4

Handle Adjustments

The handle on this vacuum cleaner can be set to one of three positions – upright, middle or low.

How to Adjust the Handle

1. To release the handle, step on the pedal at the left rear corner of the vacuum cleaner (Fig. 1).
2. Upright position – for when cleaning tools are being used or for storage (Fig 2). Handle locks in this position.
3. Middle position – for normal cleaning (Fig. 3).
4. Low position – for cleaning under furniture (Fig. 4).
*Once in the middle position, press the release pedal again to place the vacuum to the low position.



Fig. 1



Fig. 2



Fig. 3



Fig. 4

Filters

Your Carpet Pro vacuum cleaner is equipped with a secondary filter and a post filter. These filters capture fine dust particles and protect the motor from dirt. It is important to change the filters regularly – approximately once a year, or as needed.

To Change the Secondary Filter

1. Unplug the vacuum cleaner. Remove the bag compartment cover and the bag.
2. Remove the secondary filter and replace with a new filter (Fig. 5).
3. Replace the bag and bag compartment cover.



Fig. 5

NOTE: Filters cannot be washed and used again.

To Change the Post Filter

1. Unplug the vacuum cleaner. Remove the bag compartment cover.
2. Remove the foam filter from the front of the bag compartment (Fig. 6).
3. DO NOT THROW AWAY THE FILTER HOLDER.
4. Insert a new filter into the holder and replace the bag compartment cover.



Fig. 6

Edge Cleaning Feature

The edge cleaning feature provides improved cleaning of carpets near walls and stationary furniture. For maximum edge cleaning, use the left side of the vacuum near walls or stationary furniture.

Automatic Self-Adjusting Nozzle

Your Carpet Pro upright vacuum cleaner is designed with an Automatic Self-Adjusting Nozzle. No manual adjustments are required. The height of the nozzle is instantly and automatically adjusted to carpet pile height. This self-adjusting feature allows the nozzle to float evenly over all carpet pile surfaces.

Optional Cleaning Tools/Accessories

Deluxe Attachment Set 05.119 (Fig. 1)

- 15-foot hose
- Extension wand (2 pieces)
- Dusting brush
- Crevice tool
- Upholstery tool with brush
- Deluxe floor brush



Fig. 1

Standard Attachment Set 05.123 (Fig. 2)

- 7-foot hose
- Extension wand (2 pieces)
- Dusting brush
- Crevice tool
- Upholstery tool with brush



Fig. 2

Connecting the hose assembly to the vacuum cleaner

Open the lid located on the back side of the vacuum cleaner and insert the plastic end of the hose assembly into the cleaning attachment opening (Fig. 3). Then connect a tool to the curved wand end of the hose assembly.

On-board Tool Cleaning

Select models (CPU-1T and CPU-2T) are equipped with on-board cleaning tools including a two-piece extension wand, stretch hose, dusting brush and a crevice tool.

1. Remove the extension wand from the body of the vacuum cleaner. Insert one end of the wand into the other and twist to tighten.
2. Insert any of the tools onto the end of the wand.



Fig. 3

How to Replace the Vacuum Belt and Headlight Bulb

CAUTION: Unplug the vacuum cleaner before performing any of these steps.

How to Remove the Bottom Plate

1. Place the vacuum cleaner in the low position by pressing the handle release pedal twice. Turn the vacuum over.
2. Remove the two screws holding the bottom plate in place (Fig. 1).
3. Remove the bottom plate.

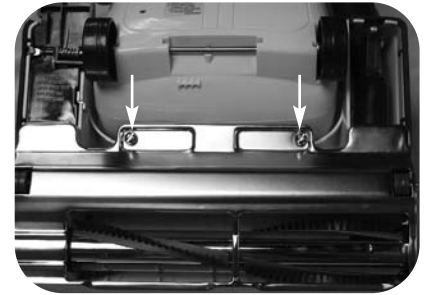

Fig. 1

How to Replace the Belt

1. Turn the unit over and remove the bottom plate as described in the above section.
2. Remove the belt guard (Fig. 2). Remove the agitator by pulling it straight out (Fig. 3).
3. Remove the belt from the agitator.
4. Loop a new belt over the motor pulley (Fig. 4) and over the end of the agitator.
5. Stretch the belt over the agitator while inserting it back into the nozzle housing.
6. Reinsert the belt guard.
7. Replace the bottom plate by hooking the front end of the plate into the two ribs on the front end of the nozzle housing. Press the bottom plate into place and fasten it with the two screws.



Fig. 2



Fig. 3

NOTE: To ensure maximum cleaning efficiency, check the belt regularly to ensure it is in good condition. Replace the belt if it is stretched, cracked or if excessive slipping is occurring.

How to Replace the Bulb (CPU-1 and CPU-1T models only) (Fig. 5)

1. Turn the unit over and remove the bottom plate as described in the above section.
2. To remove the bulb, grasp it gently and pull it straight out.
3. Install a new bulb by pushing it straight into the socket.
4. Replace the bottom plate as described in the above section.

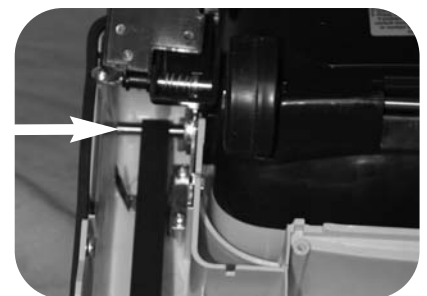

Fig. 4



Fig. 5

How to Clean the Nozzle Hose

CAUTION:

Unplug the vacuum cleaner.

The nozzle hose, located on the back of the vacuum cleaner, carries the dirt from the nozzle to the vacuum bag. The hose also functions as the attachment cleaning hose (on CPU-1T and CPU-2T models only).

If the hose should become clogged

1. Pull out and turn the lid of the cleaning attachment opening. Remove the clog or blockage (Fig. 1).
2. If the above step is not enough, remove hose cuff from the attachment port inlet (Fig. 2). Turn the unit over and unscrew and remove the bottom plate (see "How To Remove Bottom Plate."). Check nozzle inlet tube for obstructions (Fig. 3). Clear tube and reinstall the bottom plate.



Fig. 1



Fig. 2



Fig. 3

Thermal Fuse Protection

Your Carpet Pro vacuum cleaner comes equipped with a Manual Reset Thermal Fuse Protector. This thermal protector is designed to protect your vacuum cleaner from overheating due to a cutoff in airflow (i.e. clogged hose, operating the vacuum without a bag). Should this situation occur, the thermal fuse protector will safely shut off your vacuum cleaner to avoid any potential damage.

For models CPU-1 and CPU-1T only

NOTE: To determine if it was the thermal fuse protector that turned off your vacuum cleaner and not some other reason, please refer to the vacuum cleaner's headlight. **If the headlight is on while the motor is off, then the thermal fuse did safely shut down the motor.** If the headlight and motor are off, then there is some reason other than the thermal protector (i.e. pulled plug) the vacuum cleaner has shut down.

To reset the thermal fuse

1. Unplug the vacuum cleaner.
2. Check for problem (over-filled bag, clog in hose, clogged filters, etc.).
3. Correct problem.
4. Locate "tripped" fuse — the small red button located on the bottom of the back side of the main body (roughly one inch to the right of the left wheel).
5. Using a pencil, paper clip, or other pointy object, push the reset button.
6. Plug vacuum cleaner in and begin using.

Please return to your Carpet Pro Retailer with any questions.

For Best Performance

- Keep machine and all accessories clean and in good operating condition.
- Change vacuum bags and filters as recommended to maintain optimum cleaning efficiency.
- Always use genuine bags, filters and parts, as use of other products may result in poor cleaning or filtration performance. Carpet Pro filtration products are designed for maximum performance.
- Have machine checked periodically by the retailer where you purchased your Carpet Pro vacuum.
- Store machine carefully in dry area.
- For optimum cleaning performance and safety, follow your owner's manual.

CARPET · PRO

Carpet Pro Vacuum Cleaners
PO Box 730
Fenton, MO 63026

Should your vacuum ever need service, simply contact the retailer where original purchase was made.