

This Owner's Manual is provided and hosted by Appliance Factory Parts.

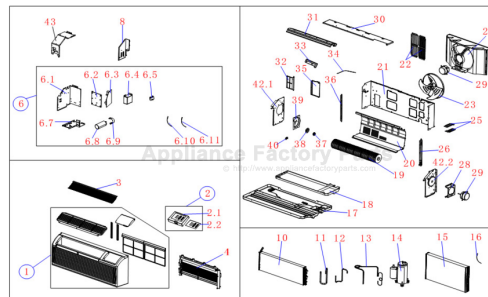

COMFORT-AIRE EKTC15G135A Owner's Manual

[Shop genuine replacement parts for COMFORT-AIRE
EKTC15G135A](#)



[Find Your COMFORT-AIRE Air Conditioner Parts - Select From 599 Models](#)

----- Manual continues below -----

HEAT CONTROLLER

**REPLACEMENT
PARTS LIST**

**Packaged Terminal
Air Conditioner:
EKTC15G135A**

EXPLODED VIEW

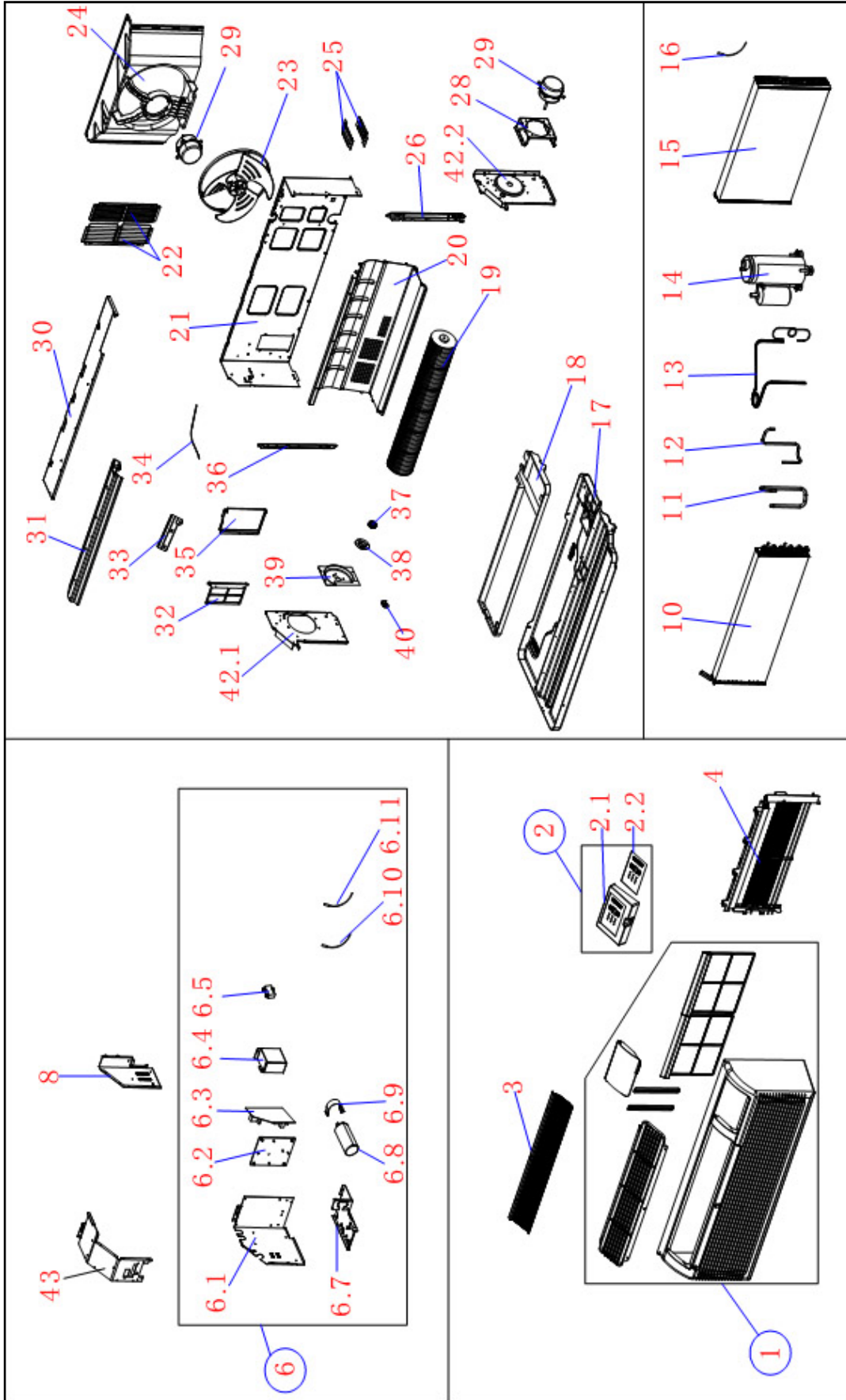

REPLACEMENT PARTS

| Location | Part Name | Quantity | Part No. |
|----------|---------------------------------------|----------|--------------|
| 1 | Panel frame assembly | 1 | 201121890174 |
| 2 | Display box assembly | 1 | 2033218A0294 |
| 2.1 | Control panel | 1 | 201121790313 |
| 2.2 | Display board assembly | 1 | 201321890072 |
| 3 | Air filter | 1 | 201221890087 |
| 4 | Electric heater | 1 | 202403100888 |
| 6 | Electronic control box assembly | 1 | 203321890150 |
| 6.1 | Cover of electronic control box | 1 | 201221790252 |
| 6.2 | Bracket of main control board I | 1 | 201121790312 |
| 6.3 | Main control board assembly | 1 | 201321790145 |
| 6.4 | Transformer | 1 | 202300900727 |
| 6.5 | Fan motor capacitor | 1 | 202401100353 |
| 6.5 | Fan motor capacitor | 1 | 202401100004 |
| 6.7 | Electronic control box | 1 | 201221790249 |
| 6.8 | Capacitor of compressor | 1 | 202401090056 |
| 6.9 | Capacitor clip | 1 | 201200100025 |
| 6.10 | Ambient temperature sensor assembly | 1 | 202440220061 |
| 6.11 | Pipe temperature sensor assembly | 1 | 202301300469 |
| 8 | Cover of electronic control box | 1 | 201221790250 |
| 10 | Evaporator coil assembly | 1 | 201521890079 |
| 11 | Suction pipe assembly | 1 | 201621890334 |
| 12 | Discharge pipe | 1 | 201621890336 |
| 13 | Capillary assembly | 1 | 201621890415 |
| 14 | Compressor | 1 | 201400611153 |
| 15 | Condenser assembly | 1 | 201521890075 |
| 16 | Discharge temperature sensor assembly | 2 | 202301310068 |
| 17 | Chassis assembly | 1 | 201221790260 |
| 18 | Water collector | 1 | 202221790021 |
| 19 | Cross flow fan | 1 | 201100200047 |
| 20 | Volute shell | 1 | 201221890085 |
| 21 | Front separating board | 1 | 201221790246 |
| 22 | Horizontal louver | 2 | 202921790001 |
| 23 | Axial flow fan | 1 | 201100300049 |
| 24 | Rear separating | 1 | 201121790307 |
| 25 | Linker for front separating board | 2 | 201221790236 |
| 26 | Fixing board right | 1 | 201221790256 |
| 28 | Supporter assembly of fan motor | 1 | 201221790245 |
| 29 | Asynchronous motor | 1 | 202400401222 |
| 29 | Asynchronous motor | 1 | 202400401221 |
| 30 | Front cover | 1 | 201221790247 |
| 31 | Volute shell assembly | 1 | 201221890086 |
| 32 | Fresh air door filter | 1 | 201121790309 |
| 33 | Connecting rod of fresh air door | 1 | 201221790239 |
| 34 | Wire, fresh air door | 1 | 201221790240 |
| 35 | Fresh air door | 1 | 201221790259 |
| 36 | Fixing board, left | 1 | 201221790255 |
| 37 | Bearing bracket | 1 | 202732390001 |
| 38 | Cover of Bearing bracket | 1 | 201221790244 |
| 39 | Wind baffle board | 1 | 201221790243 |
| 40 | Hook of Panel | 2 | 201221790248 |
| 42 | Supporter of air passage | 1 | 201221890085 |
| 42.1 | Supporter of air passage | 1 | 201221790241 |
| 42.2 | Supporter of air passage | 1 | 201221790242 |
| 43 | Cover of electronic control box | 1 | 201221790254 |

Design, material, performance data and components subject to change without notice.

HEAT CONTROLLER

1900 Wellworth Ave., Jackson, Michigan 49203 • Ph. 517-787-2100 • Fax 517-787-9341

www.heatcontroller.com

THE QUALITY LEADER IN CONDITIONING AIR