

This Owner's Manual is provided and hosted by [Appliance Factory Parts](http://ApplianceFactoryParts.com).

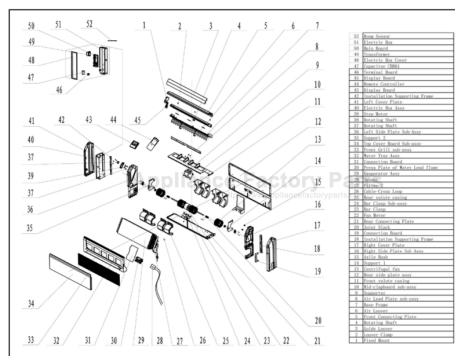

COMFORT-AIRE B-VFH18UA-1 Owner's Manual

[Shop genuine replacement parts for COMFORT-AIRE
B-VFH18UA-1](#)



[Find Your COMFORT-AIRE HVAC Parts - Select From 1486 Models](#)

----- Manual continues below -----

HEAT CONTROLLER

**REPLACEMENT
PARTS LIST**

**InverterFlex Series®
Floor & Ceiling Console Mini-Split
B-VFH18UA-1
Heat Pumps**

EXPLODED VIEW

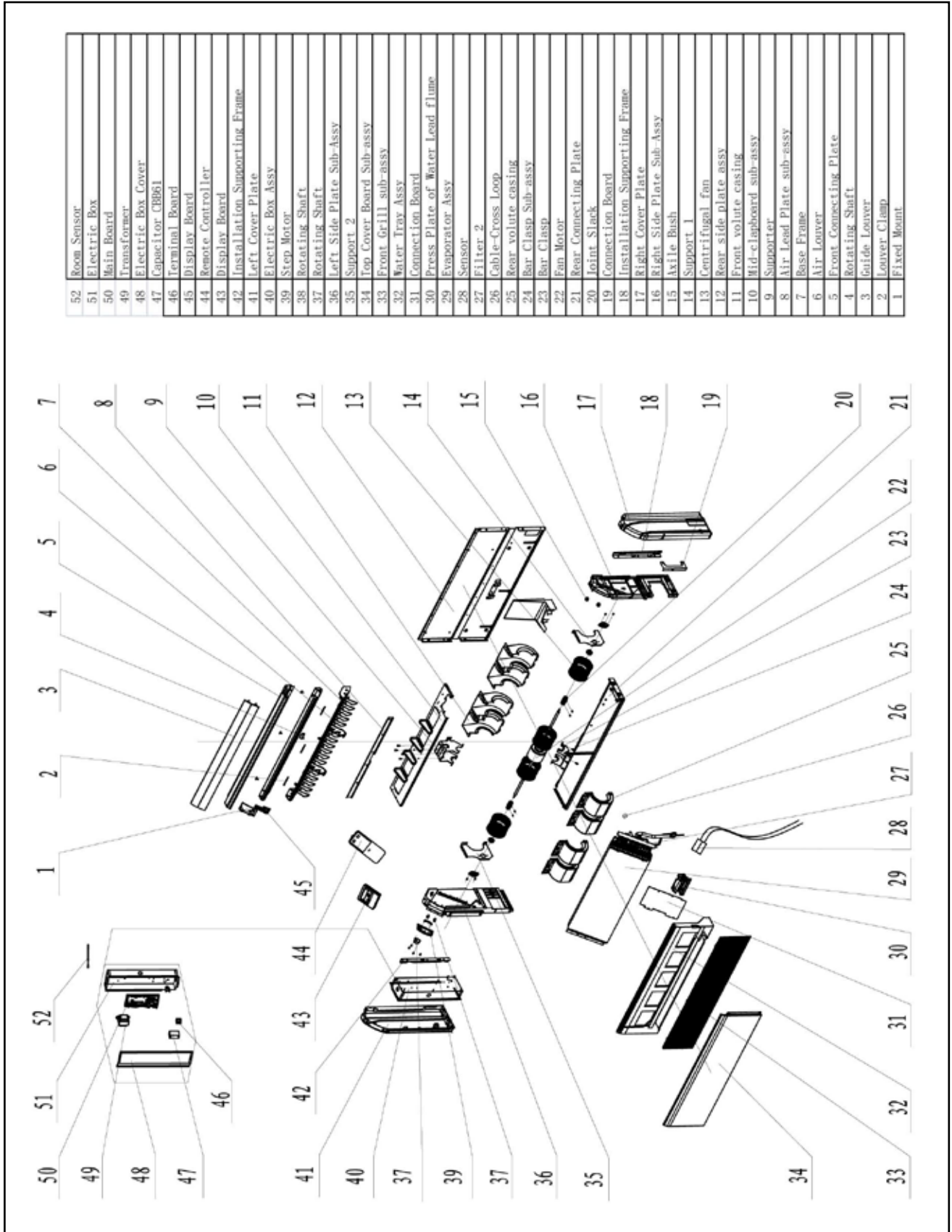

REPLACEMENT PARTS

Location	Part Name	Quantity	Part No.
1	Fixed Mount	1	26909426R
2	Louver Clamp	2	26112127
3	Guide Louver	2	10619403
4	Rotating Shaft	4	26909430
5	Front Connection Plate	1	01349414P
6	Air Louver	16	10619404
7	Base Frame	1	26909448
8	Induced air plate subassembly	1	02229418
9	Supporter	1	01805288
10	Mid Clapboard Sub-assy	1	01249427
11	Front Volute Casing	4	26905205
12	Rear Side Plate Assy	1	01319440
13	Centrifugal Fan	4	10425200
14	Support 1	1	01809417
15	Axile Bush	2	10542704
16	Right Side Plate Sub-Assy	1	01319429
17	Right Cover Plate	1	26909444
18	Installation Supporting Frame	1	01809402
19	Connection Board	1	02229406
20	Joint Slack	2	73018731
21	Rear Connection board	1	01349422
22	Fan Motor	1	15704111
23	Bar Clasp	1	70818405
24	Bar Clasp sub-assy	1	70815201
25	Rear Volute Casing	4	26905206
26	Cable Cross Loop	1	76514201
27	Filter	1	07216221
28	Temperature Sensor	1	3900019822
29	Evaporator Assy	1	01029469
30	Plate Board of Water Releasing Flume	1	26909442
31	Connection Board	1	01344115
32	Water Tray Assy	1	01289404
33	Front Grill sub-assy	2	01579403
34	Top Cover Board Sub-assy	1	01269409
35	Support 2	1	01809418
36	Left Side Plate Sub-Assy	1	0131942801
37	Rotating Shaft	1	26909412
38	Rotating Shaft	1	26909413
39	Stepping Motor	1	1521240206
40	Electric Box Assy	1	02404653
41	Left Cover Plate	1	26909443
42	Installation Supporting Frame	1	01809401
43	Display Board	1	30296317_L08294
44	Remote Controller	1	305100501_L08294
45	Display Board	1	30294220
46	Terminal Board	1	420111041
47	Capacitor CBB61	1	33010026
48	Electric Box Cover	1	01429420
49	Transformer	1	43110257
50	Main Board	1	30226350
52	Temperature Sensor	1	390001978G

Due to ongoing product improvements, specifications and dimensions are subject to change and correction without notice or incurring obligations. Determining the application and suitability for use of any product is the responsibility of the installer. Additionally, the installer is responsible for verifying dimensional data on the actual product prior to beginning any installation preparations.

Incentive and rebate programs have precise requirements as to product performance and certification. All products meet applicable regulations in effect on date of manufacture; however, certifications are not necessarily granted for the life of a product. Therefore, it is the responsibility of the applicant to determine whether a specific model qualifies for these incentive/rebate programs.

HEAT CONTROLLER

1900 Wellworth Ave., Jackson MI 49203 • Ph. 517-787-2100 • www.heatcontroller.com

A  Company