

This Owner's Manual is provided and hosted by [Appliance Factory Parts](#).



Alfresco AKK Owner's Manual

[Shop genuine replacement parts for Alfresco AKK](#)



[Find Your Alfresco Grill Parts - Select From 126 Models](#)

----- Manual continues below -----

Alfresco™ KEG KIT (AKK) FOR URS-1 UNIT

KIT DESCRIPTION:

Your ALFRESCO™ URS-1 refrigerator has been design with enough interior volume to hold and refrigerate a standard US half size beer keg (15 gallons).

In addition, the refrigerator allows the installation of a beer faucet and support arm that will allow you to serve "Beer-on-Tap".

This optional equipment allows you to install an under counter Keg Tap system as well as a movable unit if installed with the optional caster kit.

Alfresco

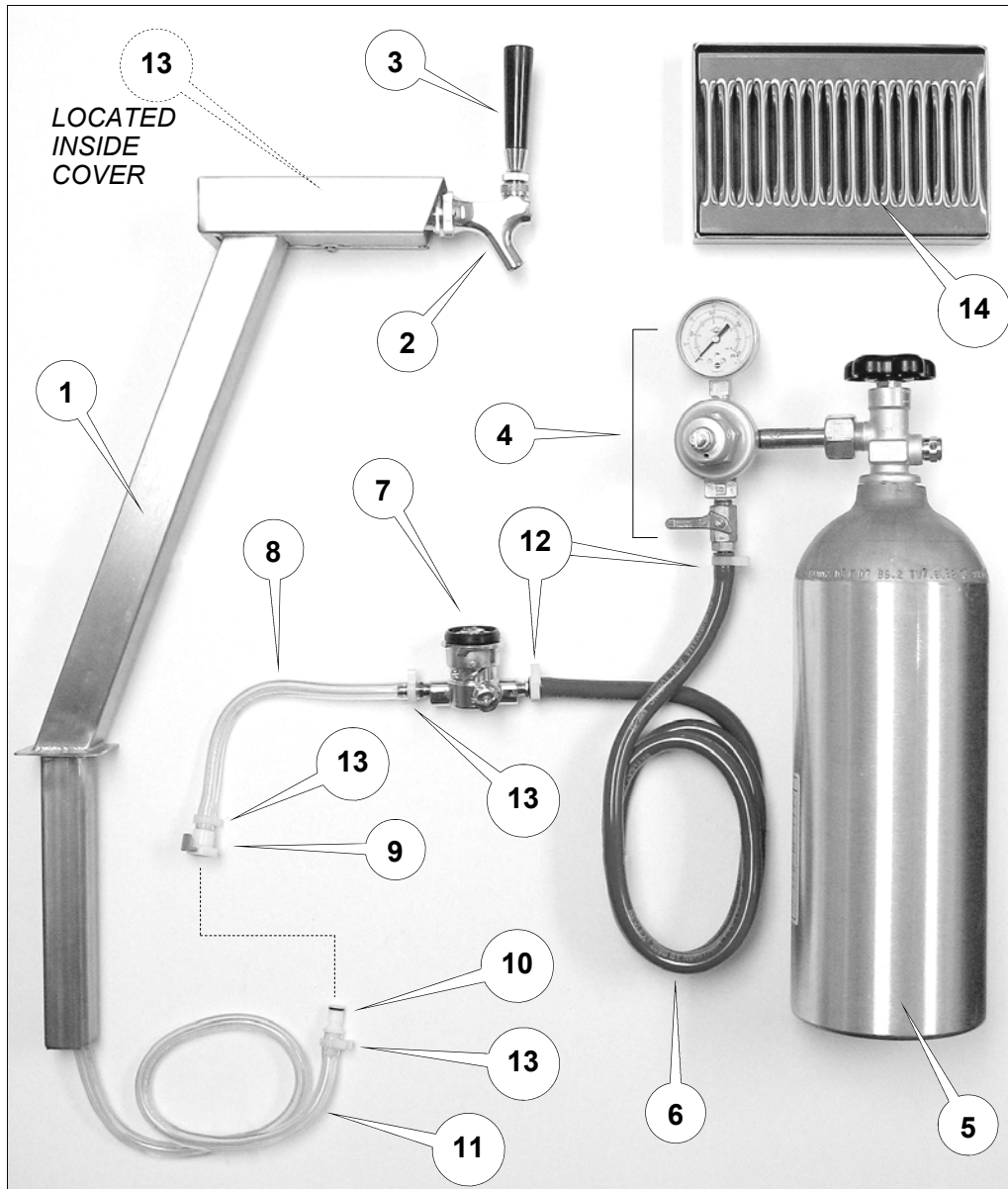

KEG KIT COMPONENTS

N°	Description	Part N°	Qty
1	Support Arm (Stainless Steel)	510-0113	1
2	Beer Faucet (BEER TAP)	190-0006	1
3	Faucet Handle (Black)	190-0100	1
4	Pressure Regulator / Gauge / Shut-Off Valve Assembly	190-0001	1
5	Aluminum 5 Lbs. CO ₂ Bottle	190-0000	1
6	CO ₂ Pressure Line (5/16" Ø ID x 36" Long - BLUE Color)	190-0026	1
7	Sanitary Key (SANKEY) Low Profile "D" System Perlick™ Type	190-0003	1
8	Beer Line (3/16"Ø x 12" Long - NSF® - CLEAR Color)	190-0028	1
9	Quick Connector - CPC 1/4"Ø - Female	220-0158	1
10	Quick Connector - CPC 1/4"Ø - Male	220-0157	1
11	Beer Line (3/16"Ø x 60" Long - NSF® - CLEAR Color)	190-0027	1
12	Tubing Clamp - 5/16" Ø ID Size - Plastic	190-0025	2
13	Tubing Clamp - 1/4" Ø ID Size - Plastic	190-0035	4
14	Drip Tray Assembly (Stainless Steel)	300-0091	1

Alfresco Gourmet Grills.

1085 Bixby Drive
City of industry, CA 91745.

☎ (888) 383-8800 or (323) 722 7900

📠 (323) 726 4700.

KEG KIT INSTALLATION:

1. On the back top section of your refrigerator there is an opening provided for the faucet support arm (see picture 1 & 2).
2. Remove the cover as shown on picture 2 by lifting the cover straight out exposing the opening
3. Remove the beer line access hole plug located on the inside of the refrigerator, just below evaporator. (See picture 3 & 4)
4. Insert the beer line (3/16"Ø ID / clear color tubing) from the top of the refrigerator and allow it to drop to the inside of the refrigerated compartment.

NOTE 1: The beer line travels through the back section of the unit into the refrigerated compartment by following the faucet arm support structure located behind the refrigerator's back cover. (See picture 5)

NOTE 2: Verify that the beer line is not in direct contact with the evaporator wall of the air discharge grill. If the beer line should come in contact with this parts it might freeze the beer inside the line and cause a blockage.

5. Once the beer line has been inserted all the way to the refrigerated section, insert the support arm into the top opening.
6. Install the pressure regulator to the CO₂ bottle and tighten securely using a wrench in order to avoid CO₂ leakage.
7. Close the ball valve in the regulator and open the CO₂ bottle valve.
8. Adjust the regulator to a pressure between 8 ~ 10 PSI using the regulator set screw.

NOTE 3: More than 10 PSI of pressure will cause the beer to foam up at the tap, maintain the pressure between 8 ~ 10 PSI for optimum performance.

9. Connect the CO₂ line (5/16"Ø ID / Blue color tubing) to the regulator and Sanitary Key [SANKEY] and install the hose clamps provided in order to secure the tubing to the hose barbed fittings.
10. Install the Sanitary Key [SANKEY] on the beer keg and connect the beer line from the faucet arm to the SANKEY. Secure the tubing with the clamps provided.

NOTE 4: The SANKEY provided is a standard US "D" Style keg tap also known as Perlick™ type. For specialty beers that might require other connections please go to : <http://www.beveragefactory.com> or call 1-800-710-9939 for assistance.

11. Open the CO₂ regulator ball valve slowly and pressurize the keg.
12. Open the TAP faucet slowly to allow the beer to flow through the system.
13. Locate the Keg and CO₂ bottle inside the refrigerator.

NOTE 5: Maintain beer between 34°F and 38°F for proper flow and foam. If beer is over 38°F it will foam out easily.

14.

ENJOY!



Picture 3

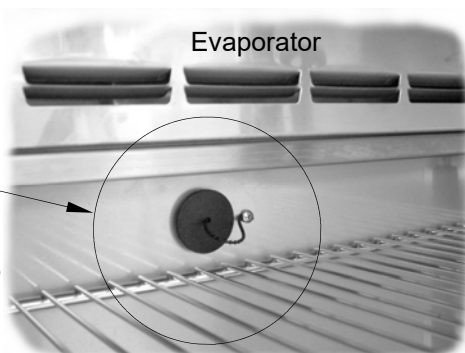

Picture 4



Picture 1

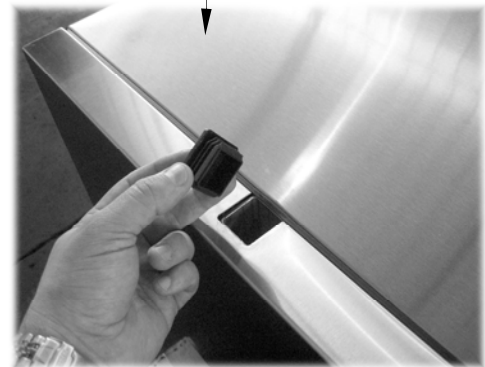

Picture 2

REFRIGERATOR'S BACK

Faucet Arm Support structure

Evaporator Drain Line

Condenser

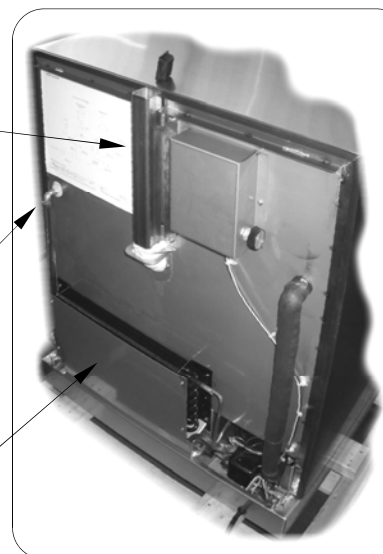

Picture 5

NOTE: There is no need to remove the refrigerator's back in order to install the beer line. Illustrations are for reference only.